

Facility Needs Assessment - Preliminary Concept Plan

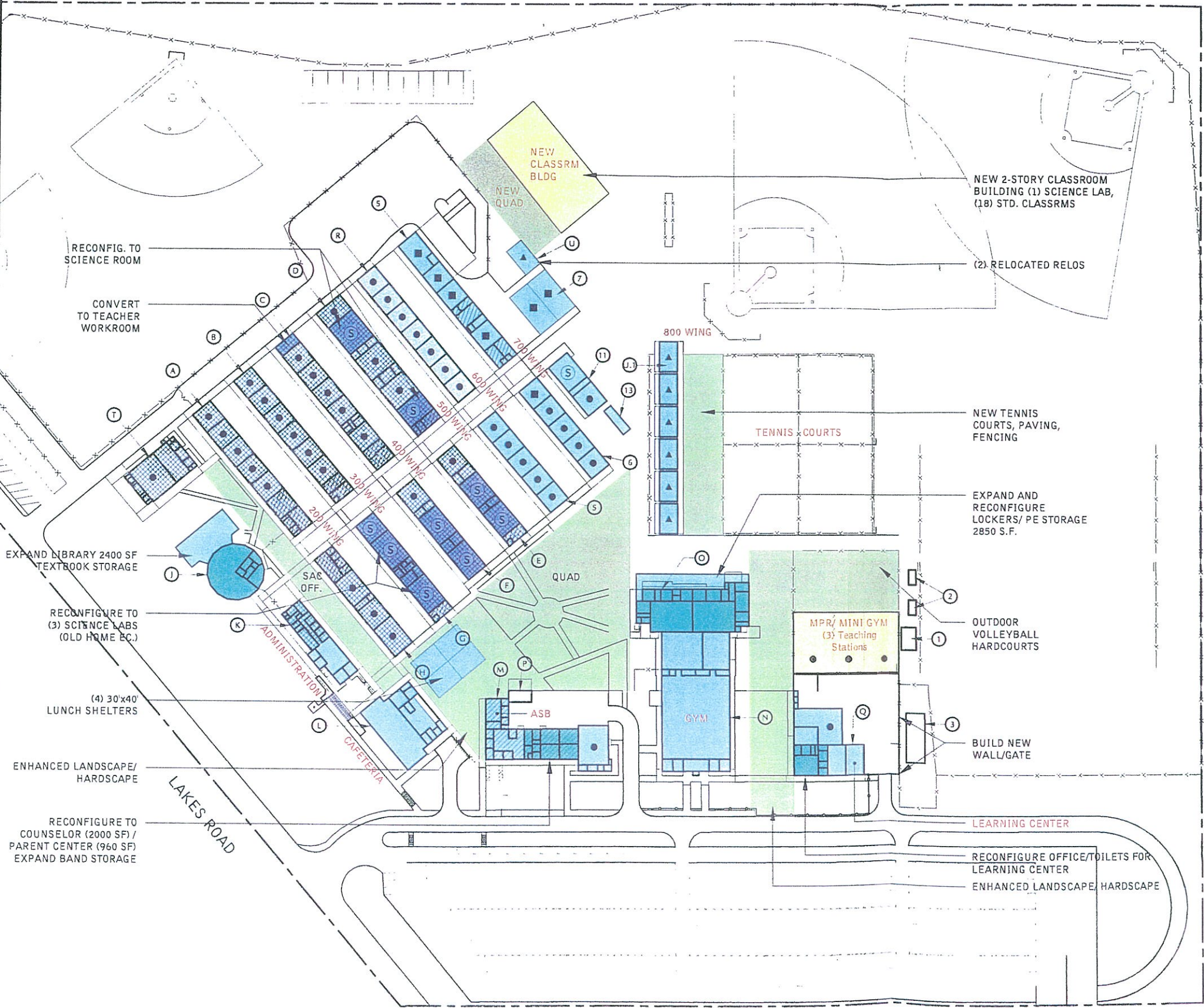

CBEDS 2001	= 2,722 students
SUGGESTED FUTURE ENROLLMENT	= 2,550 students
Maturity	= 2,028 w/out boundary adjustments
Peak Enrollment	= Now. 2001.
Potential Boundary Adjustment or Enrollment Policy Change	= with ORHS & EHS, shift approx. 330 students

CAPACITY W/ SPECIAL ED.	83(30)+7(13) S.E.
	=2490+91 S.E.
	=2581 Students

NEW CLASSROOM BUILDING INCLUDES:
(1) Science Labs
(18) Classrooms, Staff & Student Restrooms & Staff Workroom
(3) Dance @ MiniGym Classroom
w/ Operable Wall = 22 NEW CLASSROOMS

Teaching Stations	= 85 Classrooms @ 30 loading
SPECIAL ED	= 59/27 Students
S/NS 2001	= 7 Classrooms @ 13 loading
Learning Center	= 87 Students

LEGEND

- Permanent Classroom
- Relocatable Classrooms
- Science Labs
- Special Ed Classrooms
- Support / Administration

Scope #1

- Modernization (60/40 State/District)
- Modernization (Remaining Measure BB Funds)
- Reconfiguration (Remaining Measure BB Funds)

Scope #2

- New Construction (50/50 State/District)

Scope #3

- Modernization/Expansion/ New Construction (100 % District)
- Reconfiguration (100 % District)
- Enhance Hardscape/Landscape

Facility Needs Assessment and Master Plan

Bonita Vista High School
Sweetwater Union High School District

School Summary Break-out By Building

Summary By Category

#	Building	Area	Unit	Category					Total \$
				Modernization	Technology	ADA/Life Sfty	Reconfiguration	Augmentation	
A Classroom		6,301	SF	\$699,338	\$117,741	\$130,166			\$947,245
B Classroom		6,300	SF	\$607,028	\$108,518	\$179,173			\$894,719
C Classroom		6,301	SF	\$689,811	\$101,355	\$129,534	\$13,542		\$934,242
D Classroom		8,401	SF	\$1,256,332	\$168,755	\$221,754	\$162,675		\$1,809,516
E Classrooms		4,500	SF	\$649,139	\$71,061	\$264,281	\$208,863		\$1,193,344
F Science Classrooms		4,500	SF	\$754,570	\$85,355	\$92,490	\$208,863		\$1,141,278
G Science Classrooms		4,952	SF	\$554,455	\$81,362	\$231,211	\$332,130		\$1,199,158
H Classroom		3,750	SF	\$475,997	\$69,442	\$65,178			\$610,617
J Library		6,701	SF	\$476,912	\$46,383	\$45,816	\$52,409	\$582,744	\$1,204,264
K Administration		3,803	SF	\$331,813	\$60,769	\$146,517			\$539,099
L Multi-Purpose		6,273	SF	\$683,682	\$109,132	\$190,414			\$983,228
M Shop & Band		8,394	SF	\$1,090,809	\$157,296	\$199,393	\$77,374		\$1,524,872
N Gym & Adaptive		14,181	SF	\$1,193,153	\$234,022	\$227,681			\$1,654,856
O Men's & Women's Shower & Locker		11,143	SF	\$661,498	\$112,352	\$380,948	\$105,736	\$657,752	\$1,918,286
P Storage			SF	Not A Part Of Scope					
Q Shop - Auto & Classroom		6,793	SF	\$691,152	\$122,064	\$119,771	\$15,180		\$948,167
R Classroom		6,300	SF	\$723,162	\$124,924	\$45,375			\$893,461
S Classroom		4,500	SF	\$587,996	\$89,231	\$33,000			\$710,227
T Music & Drama		4,175	SF	\$622,392	\$91,568	\$136,158			\$850,118
U Relocatable Classroom	*	2,880	SF	\$96,812					\$96,812
V Storage	*	960	SF	\$32,479					\$32,479
Y Storage	*	960	SF	\$10,647					\$10,647
1 Storage			SF	Not A Part Of Scope					
2 Storage			SF	Not A Part Of Scope					
3 Security Residence			SF	Not A Part Of Scope					
4 Relocatable Classrooms	*	1,920	SF	\$21,294					\$21,294
5 Classroom		6,700	SF	\$738,322	\$125,915	\$209,191			\$1,073,428
6 Classroom		4,800	SF	\$535,544	\$95,180	\$70,125			\$700,849
7 Relocatable Classrooms		3,840	SF	\$372,602	\$76,144	\$37,125			\$485,871
8 Relocatable Classrooms	*	6,240	SF	\$71,033					\$71,033
9 Relocatable Classrooms	*	3,840	SF	\$42,587					\$42,587
10 Relocatable Classrooms	*	3,840	SF	\$42,587					\$42,587
11 Relocatable Classrooms		2,400	SF	\$257,774	\$47,590	\$14,080			\$319,444
12 Relocatable Restroom	*	400	SF	\$6,570					\$6,570
13 Relocatable Restroom		400	SF	\$13,042		\$106,364			\$119,406
Covered Walkways		51,144	SF	\$632,595				\$182,112	\$814,707
Sitework		N/A	SF	\$3,615,578	\$1,076,274	\$1,425,493		\$1,511,385	\$7,628,730
New Augmentation		40,500	SF					\$9,500,537	\$9,500,537
Totals		*AIA Area = 213,996	SF	\$19,238,705	\$3,372,433	\$4,701,238	\$1,176,771	\$12,434,530	\$40,923,677

Facility Needs Assessment - Preliminary Concept Plan

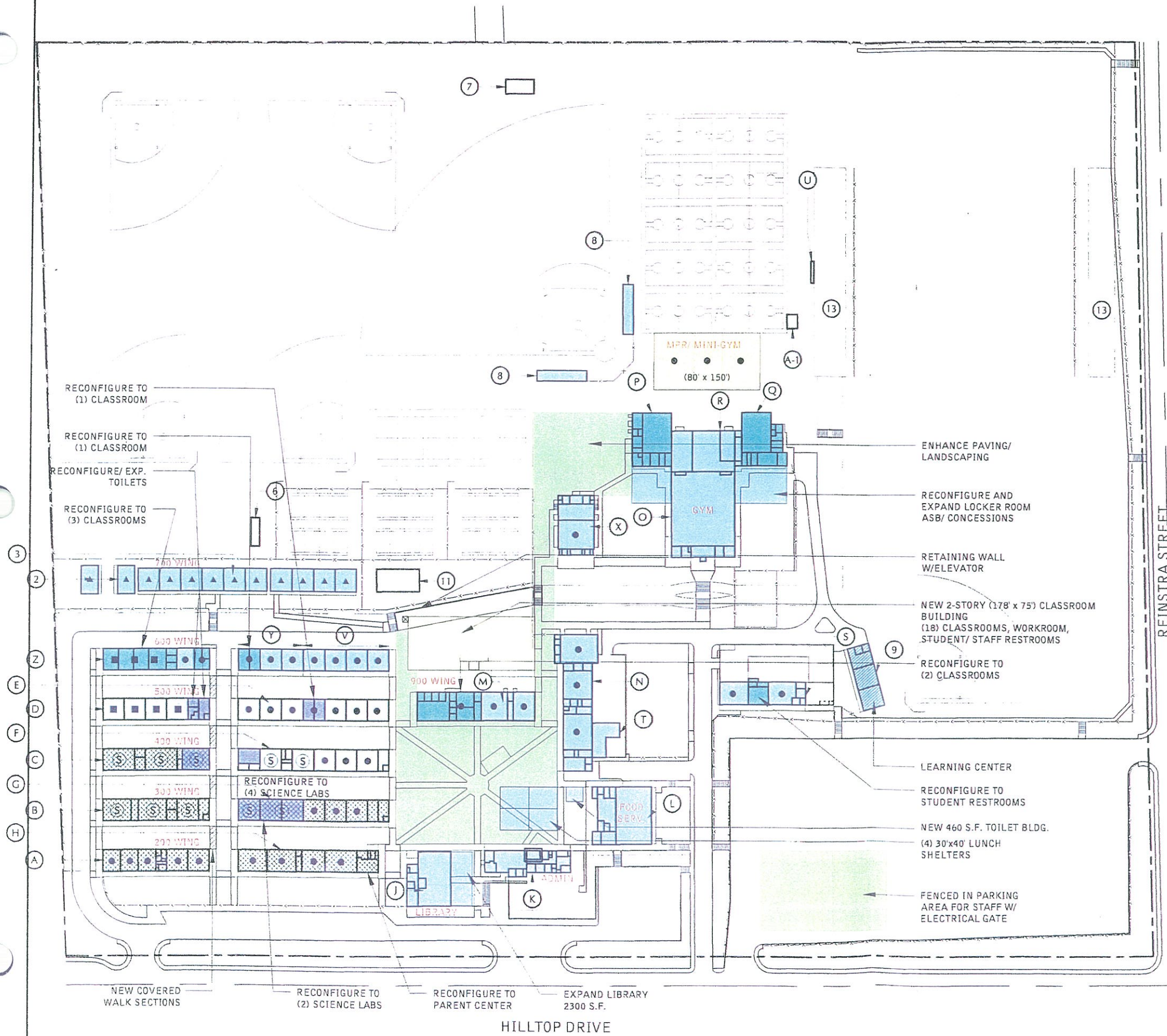

CBEDS 2001	= 2,311 students
SUGGESTED FUTURE ENROLLMENT	= 2,550 students
Maturity	= 1,973
Peak Enrollment	= Now. 2002.
Potential Boundary Adjustment or Enrollment Policy Change	= None

CAPACITY W/ SPECIAL ED.	82(30)+7(13) S.E.
	=2460+91 S.E.
	=2551 Students

New Classroom Building Includes:
(18) Classrooms, Staff & Student Restrooms & Staff Workroom
(3) Multi-purpose/ Mini Gym Classroom

SPECIAL ED	= 13/59
S/NS 2001	= 7 Classrooms @ 13 loading
Teaching Stations	= 82 Classrooms @ 30 loading
Learning Center	= 133 Students

LEGEND

- Permanent Classroom
- Relocatable Classrooms
- Science Labs
- Special Ed Classrooms
- Support / Administration

- Scope #1
- Modernization (60/40 State/District)
 - Modernization (Remaining Measure BB Funds)
 - Reconfiguration (Remaining Measure BB Funds)

- Scope #2
- New Construction (50/50 State/District)

- Scope #3
- Modernization/Expansion/ New Construction (100 % District)
 - Reconfiguration (100% District)
 - Enhance Hardscape/Landscape

Job No. 22037.10
Filename CastleParkHMP
Date 08-13-03
Scale 1" = 150'
Sheet

17848 Sky Park Circle
Irvine, California 92614
P 949 263-1001
F 949 263-1190
E lpa@lpa.com
W www.lpa.com

LPA
Architecture
Planning
Interior Design
Landscape Architecture
Graphics

Castle Park High School
Sweetwater Union High School District
1395 Hilltop Drive, Chula Vista, CA 91911

Facility Needs Assessment and Master Plan

Castle Park High School
Sweetwater Union High School District

School Summary Break-out By Building

Summary By Category

#	Building	Area	Unit	Category					Total \$
				Modernization	Technology	ADA/Life Sfty	Reconfiguration	Augmentation	
	A Classroom - Home Economics	4,500	SF	\$492,109	\$79,417	\$124,917			\$696,443
	B Classroom - Science	4,500	SF	\$668,389	\$71,969	\$203,561	\$290,331		\$1,234,250
	C Classroom - Science	4,500	SF	\$772,987	\$87,649	\$86,773	\$122,583		\$1,069,992
	D Classroom	4,500	SF	\$466,372	\$71,385	\$232,521	\$67,944		\$838,222
	E Classroom	6,300	SF	\$747,069	\$124,924	\$49,500	\$23,526		\$945,019
	F Classrooms	6,302	SF	\$675,006	\$100,177	\$215,179	\$11,101		\$1,001,463
	G Classrooms	6,300	SF	\$689,911	\$108,659	\$174,340	\$126,604		\$1,099,514
	H Classroom	5,850	SF	\$580,139	\$105,076	\$130,503			\$815,718
	J Library	6,570	SF	\$432,751	\$48,226	\$26,554		\$524,470	\$1,032,001
	K Administration	3,801	SF	\$372,948	\$63,132	\$110,570			\$546,650
	L Multi-Purpose	6,219	SF	\$734,109	\$113,996	\$80,652			\$928,757
	M Arts Bldg	6,600	SF	\$1,045,294	\$142,240	\$111,742	\$106,838		\$1,406,114
	N Shop & Band	8,420	SF	\$1,097,877	\$159,661	\$183,685			\$1,441,223
	O Gymnasium	11,639	SF	\$1,048,932	\$202,283	\$192,684			\$1,443,899
	P Girl's Shower & Locker	6,594	SF	\$368,373	\$54,609	\$214,406	\$173,869	\$634,673	\$1,445,930
	Q Boy's Shower & Locker	7,621	SF	\$385,332	\$58,705	\$189,661	\$173,869	\$807,765	\$1,615,332
	R Adaptive	4,878	SF	\$446,485	\$85,121	\$53,688			\$585,294
	S Classroom	5,388	SF	\$563,738	\$95,544	\$114,218	\$31,500		\$805,000
	T Storage	89	SF	\$6,553	\$276	\$5,404			\$12,233
	U Press Box	89	SF	\$5,762	\$276	\$7,110			\$13,1
	V Classroom	3,600	SF	\$468,588	\$71,385	\$49,500			\$589,473
	W Resource Center	1,800	SF	\$20,420					\$20,420
	X Music & Drama	4,176	SF	\$622,424	\$91,571	\$107,293			\$821,288
	Y Classroom	2,700	SF	\$348,594	\$53,539	\$56,322	\$25,094		\$483,549
	Z Classroom	4,500	SF	\$565,133	\$87,542	\$88,511	\$98,025		\$839,211
	A-1 Men & Women Toilets	300	SF	\$9,672		\$80,200			\$89,872
	1 Relocatable Restroom	400	SF	\$6,570					\$6,570
	2 Relocatable Classroom	960	SF	\$11,741					\$11,741
	3 Relocatable Classrooms	10,560	SF	\$1,112,492	\$209,396	\$59,455			\$1,381,343
	4 Relocatable Classrooms	3,840	SF	\$35,271					\$35,271
	5 Relocatable Classrooms	3,840	SF	\$46,245					\$46,245
	6 Relocatable Restroom	400	SF	\$13,042		\$101,248			\$114,290
	7 Pump House		SF	Not A Part Of Scope					
	8 Dugout	2,100	SF	\$107,104	\$6,510	\$87,290			\$200,904
	9 The Learning Center	2,700	SF	\$251,627	\$53,471	\$88,885	\$70,578		\$464,561
	10 Snack Bar	400	SF	\$6,570					\$6,570
	11 Live-On		SF	Not A Part Of Scope					
	Covered Walkways	55,200	SF	\$687,965				\$182,112	\$870,077
	Sitework	N/A	SF	\$8,130,404	\$1,273,640	\$1,589,003		\$1,125,188	\$12,118,235
	New Augmentation	37,800	SF					\$9,051,144	\$9,051,144
Totals		*AIA Area = 209,136	SF	\$24,043,998	\$3,620,379	\$4,815,375	\$1,321,861	\$12,325,352	\$46,126,965

Facility Needs Assessment - Preliminary Concept Plan

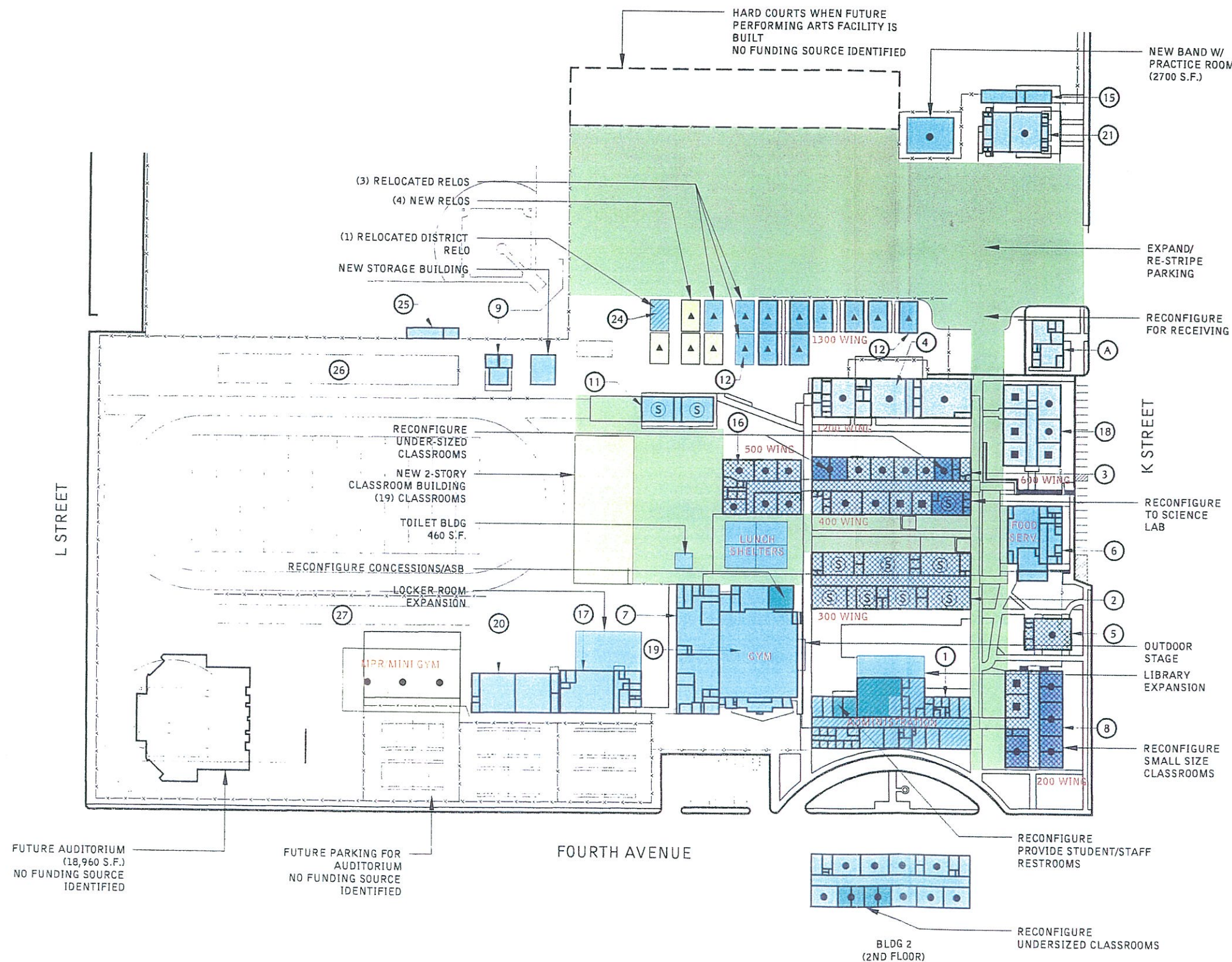

CBEDS 2001 = 2,720 students

SUGGESTED FUTURE ENROLLMENT = 2,550 students

Maturity = 3,453

Peak Enrollment = 3,475 @ '08

Potential Boundary = Between Hilltop H.S.

Adjustment or Enrollment Policy Change = Move 1,075 students to Hilltop

CAPACITY W/ SPECIAL ED. = 83(30)+8(13) = 2490+104 S.E. = 2594 Students

New Classroom Building Includes:

(19) Classrooms, Staff & Student Restrooms & Staff Workroom

(1) Multi-purpose/ Mini Gym Classroom

(1) Band

(4) New Relocatables

Learning Center

SPECIAL ED = 1/97 Students

S/NS 2001 = 8 Classrooms @ 13 loading

Teaching Stations = 83 Classrooms @ 30 loading

Learning Center = 129 Students (Bldg 'A')

LEGEND

- Permanent Classroom
- Relocatable Classrooms
- Science Labs
- Special Ed Classrooms
- Support / Administration

Scope #1

- Modernization (60/40 State/District)
- Modernization (Remaining Measure BB Funds)
- Reconfiguration (Remaining Measure BB Funds)

Scope #2

- New Construction (50/50 State/District)

Scope #3

- Modernization/Expansion/ New Construction (100 % District)
- Reconfiguration (100% District)
- Enhance Hardscape/Landscape

Job No. 22037.10

Filename ChulaVistaHSP

Date 08-06-03

Scale 1" = 150'

Sheet

17848 Sky Park Circle
Irvine, California 92614

P 949 | 261-1001
F 949 | 260-1190
E lpa@lpainc.com
W www.lpainc.com

LPA
Architecture
Planning
Interior Design
Landscape Architecture
Graphics

Chula Vista High School

Sweetwater Union High School District
820 4th Avenue, Chula Vista, CA 91911

Facility Needs Assessment and Master Plan

Chula Vista High School
Sweetwater Union High School District

School Summary Break-out By Building

Summary By Category

#	#	Building	Area	Unit	Category					Total \$
					Modernization	Technology	ADA/Life Sfty	Reconfiguration	Augmentation	
	1	Administration	35,368	SF	\$2,812,975	\$429,996	\$1,197,577	\$127,262	\$582,744	\$5,150,554
	2	Classroom - Home Economics	14,698	SF	\$1,825,848	\$201,928	\$435,587	\$384,206		\$2,847,569
	3	Classroom	15,104	SF	\$1,722,507	\$229,149	\$329,829	\$198,773		\$2,480,258
	4	Shop Building	14,875	SF	\$1,181,038	\$196,140	\$244,250		\$528,627	\$2,150,055
	5	Music	2,403	SF	\$513,835	\$179,918	\$106,086			\$799,839
	6	Cafeteria	5,640	SF	\$616,590	\$97,757	\$193,839			\$908,186
	7	Boy's Shower & Locker	9,083	SF	\$782,119	\$138,087	\$327,183			\$1,247,389
	8	Classroom - Business	9,108	SF	\$930,360	\$140,135	\$89,434	\$31,095		\$1,191,024
	9	Restroom Building (modernize)	1,458	SF	\$47,120		\$370,784			\$417,904
	10	Relocatable Classroom (demo)	9,600	SF	\$88,178					\$88,178
	11	Relocatable Classrooms - Science	2,881	SF	\$568,571	\$61,901	\$34,375			\$664,847
	12	Relocatable Classrooms - relocate and reflow	2,880	SF	\$96,356					\$96,356
	13	Relocatable Classrooms (demo)	5,778	SF	\$60,354					\$60,354
	14	Relocatable Restroom (demo)	400	SF						
	15	Storage (demo)	2,912	SF						
	16	Classroom	7,004	SF	\$743,394	\$115,985	\$61,793			\$921,172
	17	Girl's Shower & Locker	8,268	SF	\$474,712	\$77,125	\$207,853		\$675,061	\$1,434,751
	18	Classrooms	7,700	SF	\$819,994	\$120,414	\$74,928			\$1,015,336
	19	Multi-Purpose	15,360	SF	\$1,527,380	\$261,109	\$294,674			\$2,083,163
	20	Adaptive	5,504	SF	\$444,178	\$88,125	\$117,088			\$649
	21	Music & Drama	4,317	SF	\$635,915	\$94,155	\$149,998			\$880,068
	22	Relocatable Classrooms (leased / remove)	2,880	SF	\$31,940					\$31,940
	23	Relocatable Classrooms	400	SF	\$6,570					\$6,570
	24	Relocatable School District Office (relocate)	720	SF	\$19,161					\$19,161
	25	Press Box	501	SF	\$26,373	\$1,550	\$24,336			\$52,259
	A	Learning Center	2,424	SF	\$333,160	\$53,571	\$69,328	\$30,613		\$486,672
		Covered Walkways	26,746	SF	\$299,563				\$182,112	\$481,675
		Sitework	N/A	SF	\$6,959,267	\$1,607,031	\$1,852,322		\$2,550,108	\$12,968,728
		New Augmentation	67,700	SF					\$20,455,397	\$20,455,397
		Totals	'AIA Area = 263,880	SF	\$23,567,458	\$4,094,076	\$6,181,264	\$771,949	\$24,974,049	\$59,588,796

Facility Needs Assessment - Preliminary Concept Plan

SUGGESTED FUTURE
ENROLLMENT = 2,800 students
Peak Enrollment = 3,414 - '09
Potential Boundary = Future H.S.
Adjustment or Enrollment and BVHS
Policy Change

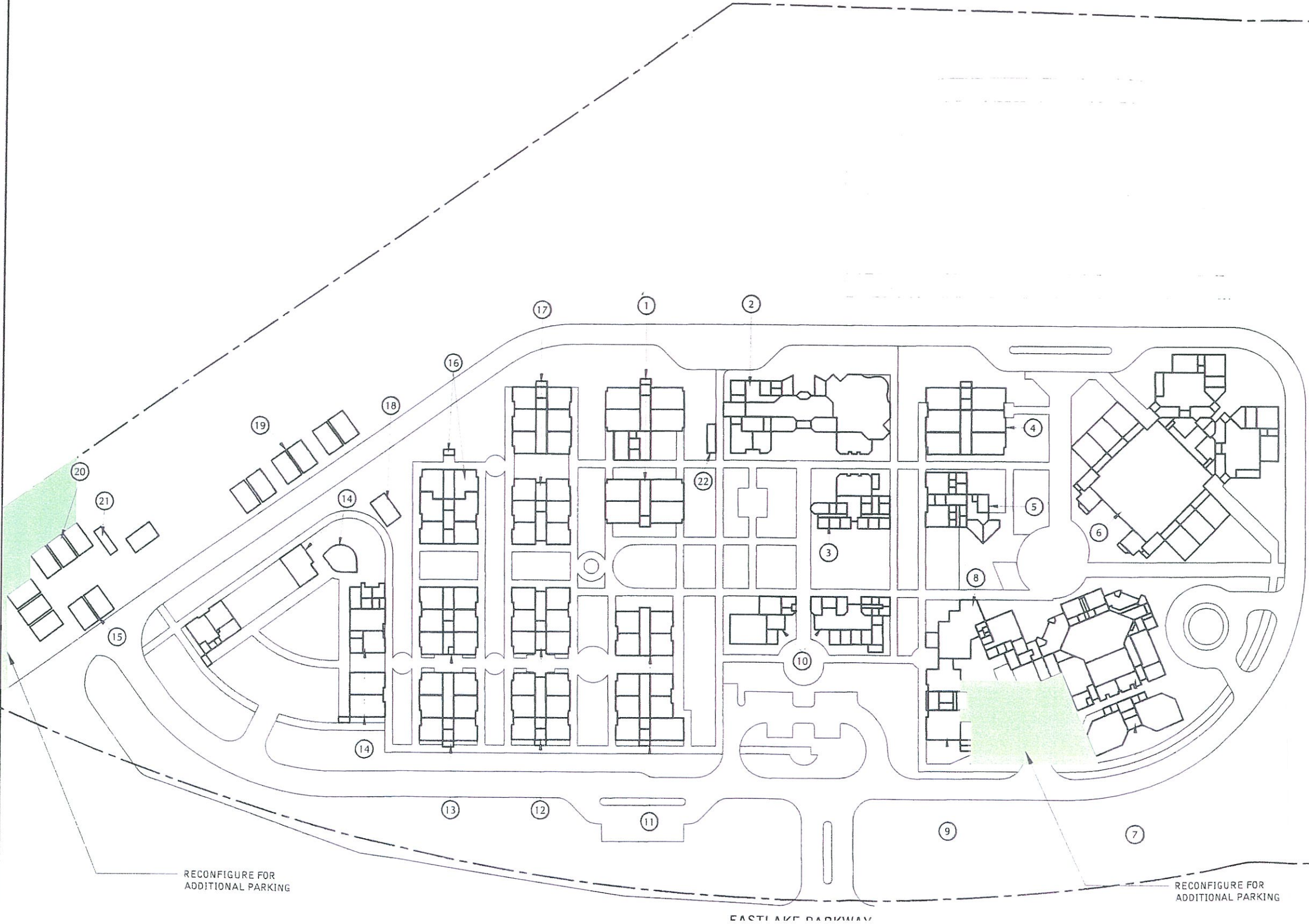

LEGEND

- Permanent Classroom
- Relocatable Classrooms
- Science Labs
- Special Ed Classrooms
- Support / Administration
- Scope #1
 - Modernization (60/40 State/District)
 - Modernization (Remaining Measure BB Funds)
 - Reconfiguration (Remaining Measure BB Funds)
- Scope #2
 - New Construction (50/50 State/District)
- Scope #3
 - Modernization/Expansion/New Construction (100% District)
 - Reconfiguration (100% District)
 - Enhance Hardscape/Landscape

Job No. 22037.10
Filename Eastlake HS MP
Date 08-06-03
Scale 1" = 150'
Sheet

17840 Sky Park Circle
Irvine, California 92614
P 949.261.1001
F 949.260.1190
E lpa@lpa-inc.com
W www.lpa-inc.com

LPA
Architecture
Planning
Interior Design
Landscape Architecture
Graphics

astlake High School
veetwater Union High School District
20 Eastlake Parkway, Chula Vista, CA 91915

Facility Needs Assessment - Preliminary Concept Plan

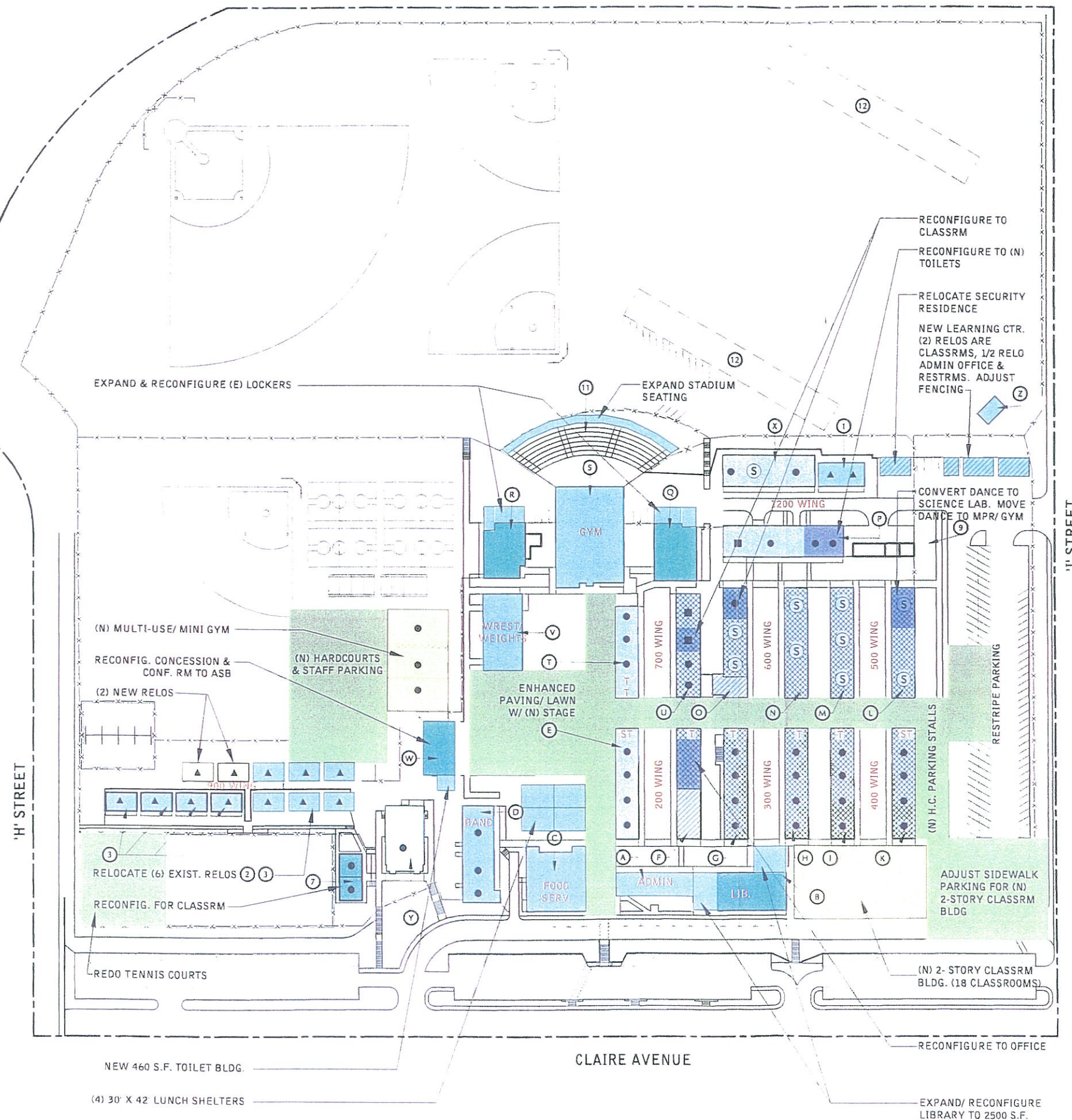

CBEDS 2001 = 2,289 students

SUGGESTED FUTURE
ENROLLMENT = 2,430 students
Maturity = 1,504
Peak Enrollment = Now.
Potential Boundary = C.V.H.S. Students
Adjustment or Move to Hilltop H.S.
Enrollment Policy Change





CAPACITY
W/ SPECIAL ED. 82(30)+3(13) S.E.
 =2460+39 S.E.
 =2499 Students

New Classroom Building Includes:



- (18) New Classrooms, Staff & Student Restrooms & Staff Workroom
- (3) Dance @ Multi-purpose/ Mini Gym
- (2) New Relos

SPECIAL ED = 38/49 Students
S/NS 2001 = 7 Classrooms @ 13 loading
Teaching Stations = 78 Classrooms @ 30 loading
Learning Center = 100 Students, program.
Move to north parking lot, new relos.

LEGEND

-  Permanent Classroom
-  Relocatable Classrooms
-  Science Labs
-  Special Ed Classrooms
-  Support / Administration

Scope #1

-  Modernization (60/40 State/District)
 Modernization (Remaining Measure BB Funds)
 Reconfiguration (Remaining Measure BB Funds)

Scope #2

- ☐
- New Construction (50/50 State/District)

Scope #3

-  Modernization/Expansion/New Construction (100 % District)
-  Reconfiguration (100 % District)
-  Enhance Hardscape/Landscape

Facility Needs Assessment and Master Plan

Hilltop High School
Sweetwater Union High School District

School Summary Break-out By Building

Summary By Category

#	Building	Area	Unit	Category					Total \$
				Modernization	Technology	ADA/Life Sfty	Reconfiguration	Augmentation	
	A Administration	3,005	SF	\$319,210	\$55,631	\$91,339			\$466,180
	B Library/Storage	6,800	SF	\$388,574	\$41,384	\$74,907	\$42,795	\$607,025	\$1,154,685
	C Cafeteria	6,162	SF	\$691,442	\$105,956	\$128,267			\$925,665
	D Band/Choral	6,682	SF	\$1,078,284	\$159,773	\$73,451			\$1,311,508
	E Classrooms	4,292	SF	\$488,950	\$77,539	\$54,857			\$621,346
	F Classrooms	4,295	SF	\$475,006	\$76,470	\$155,557	\$24,288		\$731,321
	G Classrooms	5,615	SF	\$539,113	\$80,633	\$208,432			\$828,178
	H Classrooms	4,187	SF	\$473,078	\$76,144	\$135,947			\$685,169
	J Classrooms	4,293	SF	\$476,421	\$76,541	\$135,887			\$688,849
	K Classrooms	4,292	SF	\$480,632	\$77,539	\$70,268			\$628,439
	L Classrooms	4,323	SF	\$495,794	\$81,459	\$97,246	\$123,086		\$797,585
	M Classrooms	4,323	SF	\$618,164	\$78,078	\$118,789			\$815,031
	N Classrooms	4,323	SF	\$605,364	\$77,484	\$118,698			\$801,546
	O Classrooms	4,660	SF	\$489,818	\$82,999	\$130,911	\$15,180		\$718,908
	P Shop Building	6,285	SF	\$645,001	\$100,944	\$175,149	\$306,557		\$1,227,651
	Q Boy's Shower & Locker	5,382	SF	\$348,889	\$58,389	\$160,647	\$87,052	\$332,338	\$987,315
	R Girl's Shower & Locker	4,767	SF	\$310,688	\$52,013	\$168,877	\$78,764	\$276,948	\$887,290
	S Physical Education	11,415	SF	\$1,009,879	\$196,737	\$182,231			\$1,388,847
	T Classrooms	3,572	SF	\$343,669	\$53,886	\$243,396			\$640,951
	U Classrooms	4,052	SF	\$441,733	\$72,138	\$66,475	\$23,526		\$603,872
	V Gym/Adaptive	5,000	SF	\$420,431	\$86,498	\$66,695			\$573,624
	W Art Building	2,800	SF	\$342,170	\$52,106	\$27,179	\$32,256		\$453,711
	X Drafting Bldg	4,800	SF	\$497,880	\$83,681	\$60,577			\$642,138
	Y Music/Drama	4,732	SF	\$839,517	\$109,291	\$146,616			\$1,095,424
	Z Restrooms	620	SF	\$24,540	\$81	\$149,677			\$174,298
	1 Relocatable Classrooms	1,801	SF	\$190,409	\$35,693	\$17,188			\$243,290
	2 Relocatable Classrooms (relocate)	1,920	SF	\$41,588					\$41,588
	3 Relocatable Classrooms (relocate)	3,840	SF	\$76,486					\$76,486
	4 Relocatable Restrooms (demo only)	400	SF	\$6,570					\$6,570
	5 Relocatable Classrooms (demo only)	3,840	SF	\$35,271					\$35,271
	6 Relocatable Classrooms (demo only)	1,920	SF	\$21,294					\$21,294
	7 The Learning Center	2,041	SF	\$213,184	\$40,452	\$17,188	\$12,144		\$282,968
	8 Security Resident (relo only)	1,301	SF	\$21,659					\$21,659
	9 Relocatable Classrooms (demo only)	1,920	SF	\$21,294					\$21,294
	10 Relocatable Classrooms (leased)	960	SF	\$31,941					\$31,941
	Covered Walkways	48,414	SF	\$595,331				\$182,112	\$777,443
	Sitework	N/A	SF	\$6,456,099	\$1,571,977	\$1,554,935		\$1,985,317	\$11,568,328
	New Augmentation	45,300	SF					\$10,634,810	\$10,634,810
	Totals	*AIA Area = 202,054	SF	\$20,555,373	\$3,661,516	\$4,631,386	\$745,648	\$14,018,550	\$43,612,473

Facility Needs Assessment - Preliminary Concept Plan

CBEDS 2001 = 2,399 students

SUGGESTED FUTURE
ENROLLMENT = 2,150 students
Maturity = 2,021 in '08
Peak Enrollment = Now & 2250
Potential Boundary = None
Adjustment or Enrollment Policy Change

CAPACITY
W/SPECIAL ED. = 74(30)+8(13)
= 2220+104 S.E.
= 2324 S.E.

New Classroom Building Includes:
(13) New Classrooms, Staff & Student Restrooms & Staff Workroom
(8) 2-Story Modular

SPECIAL ED
S/NS 2001 = 40/64 Students
Teaching Stations = 8 Classrooms @ 13 loading
Learning Center = 73 Classrooms @ 30 loading
= 203 Students

LEGEND

- Permanent Classroom
- Relocatable Classrooms
- Science Labs
- Special Ed Classrooms
- Support / Administration
- Phase 1A (Complete 2002)
- Phase 1B (Planning Complete)

- Scope #1
- Modernization (60/40 State/District)
 - Modernization (Remaining Measure BB Funds)
 - Reconfiguration (Remaining Measure BB Funds)
- Scope #2
- New Construction (50/50 State/District)
- Scope #3
- Modernization/Expansion/New Construction (100% District)
 - Reconfiguration (100% District)
 - Enhance Hardscape/Landscape

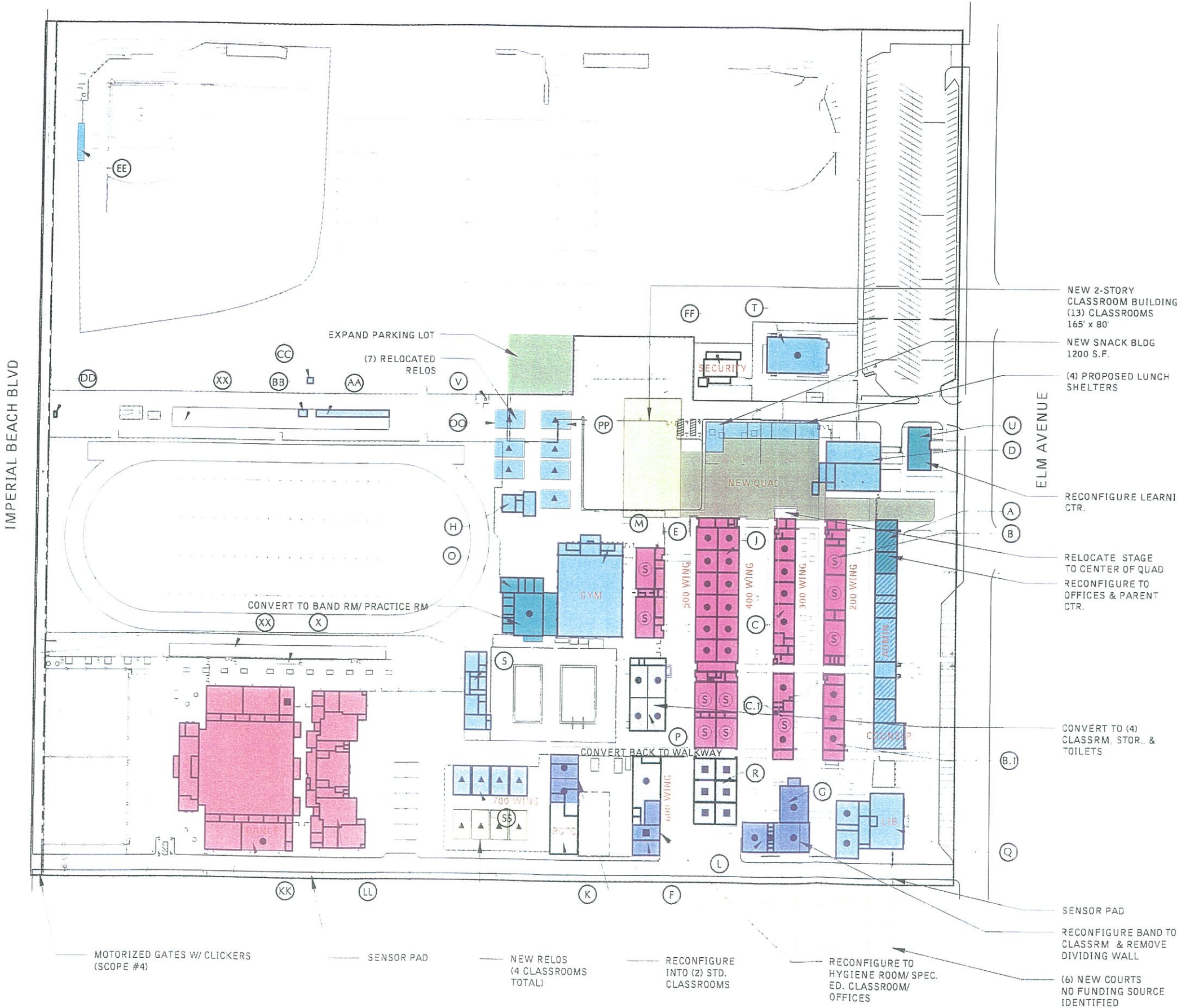

Job No. 22037.10
Filename MarVistaHSMF
Date 08-13-03
Scale 1" = 150'
Sheet

17848 Sky Park Circle
Irvine, California 92614
P 949/261-1001
F 949/260-1190
E jpa@jainc.com
W www.jainc.com

LPA
Architecture
Planning
Interior Design
Landscape Architecture
Graphics

Mar Vista High School
Sweetwater Union High School District
505 Elm Avenue, Imperial Beach, CA 91932

Facility Needs Assessment and Master Plan

Mar Vista High School
Sweetwater Union High School District

School Summary Break-out By Building

Summary By Category

#	Building	Area	Phase 1 A	Phase 1 B	Category					Total \$
			2002	2003	Modernization	Technology	ADA/Life Sfty	Reconfiguration	Augmentation	
100 A - Admin		9,535			\$1,085,414	\$165,134	\$49,603	\$22,770		\$1,322,921
200 B - Science / Class		9,135		\$1,332,233						
300 C - Art & Homemaking		9,027		\$1,291,917						
1,600 D - Cafeteria		5,217			\$670,101	\$93,402	\$71,114			\$834,617
1,000 E - Shower / Locker		5,002		\$1,088,523						
600 F - Shop		5,412			\$633,526	\$98,077	\$91,390	\$174,840		\$997,833
G - Music		2,140			\$465,687	\$53,695	\$32,166			\$551,548
1,400 H - Concessions		1,259			\$136,590	\$9,257	\$163,052			\$308,899
400 J - Wing 400		17,790		\$1,354,952						
700 K - Shop		5,380			\$630,430	\$89,737	\$116,022	\$47,716		\$883,905
300 L - Music		3,863			\$834,308	\$101,953	\$32,584	\$43,643		\$1,012,488
1,200 M - Gymnasium		11,752			\$1,143,748	\$193,876	\$152,096			\$1,489,720
N - Boiler Room (demo only)		1,200			\$12,394					\$12,394
1,100 O - Locker		4,488			\$448,058	\$62,608	\$174,576	\$199,980		\$885,222
1,010 P - Adaptive		4,975			\$535,964	\$85,912	\$63,648	\$120,412		\$805,936
200 Q - Library		6,822			\$723,136	\$99,403	\$51,009	\$52,290		\$925,838
400 R - Classroom		5,428			\$637,595	\$107,633	\$21,816			\$766,844
S - Dressing		3,335			\$343,533	\$35,529	\$139,649			\$518,711
1,700 T - Drama		4,351			\$537,970	\$51,419	\$72,630			\$662,019
U - Adult School Offices		2,400			\$270,745	\$40,172	\$112,897	\$42,381		\$466,195
V - Concession		2,800			\$390,137	\$52,896	\$21,264			\$464,297
W - Concession										
X - Press Box										
AA - Storage		1,000			\$61,357	\$3,100	\$49,817			\$114,274
BB - Storage		120			\$10,114	\$372	\$9,113			\$19,599
CC - Storage		64			\$6,272	\$198	\$6,785			\$13,255
DD - Ticket Booth		32			\$4,183	\$99	\$5,455			\$9,737
EE - Storage / Dugout		336			\$19,156	\$99	\$9,580			\$28,835
LL Boys / Girls Gym			Phase 1A 2002							
MM Relocatable Classroom (demo)		3,840			\$3,665					\$3,665
NN Relocatable Classroom (floor)		2,880			\$35,668					\$35,668
OO Relocatable Classroom (floor)		3,840			\$47,557					\$47,557
PP Relocatable Classroom (remod)		1,890			\$20,961					\$20,961
QQ Relocatable Classroom (remod)		1,920			\$21,294					\$21,294
RR Relocatable Classroom (full r)		1,920			\$259,767	\$38,072	\$8,250			\$306,089
SS Relocatable Classroom (full r)		2,975			\$390,391	\$58,992	\$12,375			\$461,758
TT Learning Center (full renov)		1,375			\$186,045	\$27,265	\$4,125			\$217,435
WW Relocatable Restrooms										
Covered Walkways		43,249			\$524,824				\$182,112	\$706,936
Sitework		N/A		\$533,739	\$2,658,520	\$189,315	\$997,838		\$324,674	\$4,170,347
Augmentation		31,440							\$6,852,985	\$6,852,985
Totals		189,359		\$5,601,364	\$13,749,110	\$1,658,215	\$2,468,654	\$704,032	\$7,359,771	\$25,939,782

Facility Needs Assessment - Preliminary Concept Plan

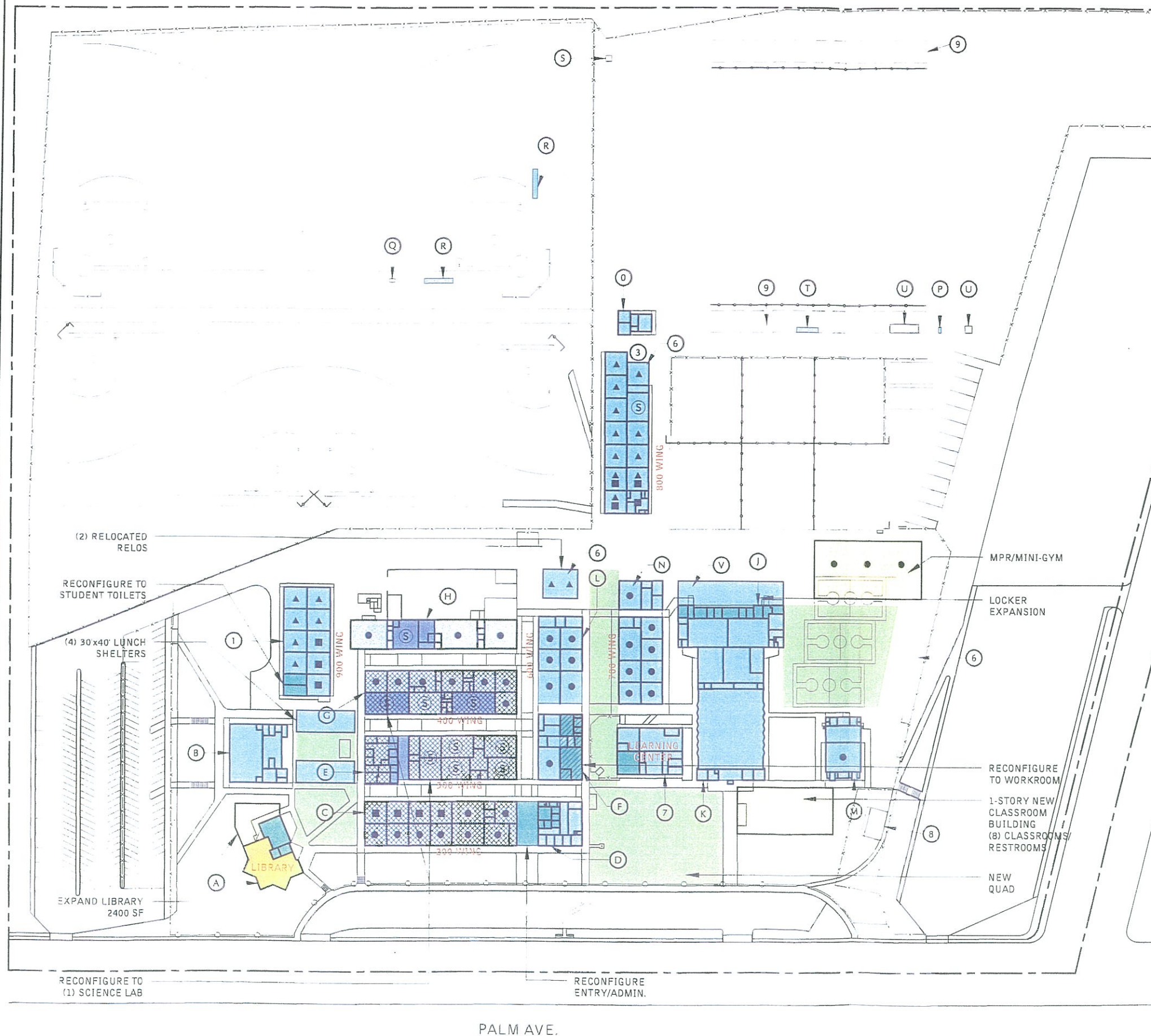

CBEDS 2001 = 2,775 students

SUGGESTED FUTURE
ENROLLMENT = 2,280 students
Maturity = 1,950
Peak Enrollment = Now.
Potential Boundary = None
Adjustment or Enrollment Policy Change

CAPACITY 71(30)+11(13) S.E.
W/SPECIAL ED. =2130+143 S.E.
=2273 Students

New Classroom Building Includes:
(8) New Classrooms, Staff & Student Restrooms & Staff Workroom
(1) Multi-purpose/ Mini Gym Classroom

SPECIAL ED = 46/81 Students
S/NS 2001 = 11 Classrooms @ 13 loading
Teaching Stations = 71 Classrooms @ 30 loading
Learning Center = 98 Students

LEGEND

- Permanent Classroom
- ▲ Relocatable Classrooms
- Ⓢ Science Labs
- Special Ed Classrooms
- ▨ Support / Administration

Scope #1

- ▨ Modernization (60/40 State/District)
- Modernization (Remaining Measure BB Funds)
- Reconfiguration (Remaining Measure BB Funds)

Scope #2

- New Construction (50/50 State/District)
- Reconfiguration/ Modernization

Scope #3

- Modernization/Expansion/ New Construction (100 % District)
- Reconfiguration (100% District)
- Enhance Hardscape/Landscape

Job No. 22037.10
Filename MontgomeryHSM
Date 08-06-03
Scale 1" = 150'
Sheet

LPA
17840 Sky Park Circle
Irvine, California 92614
P 949.261.1001
F 949.266.1190
E lpa@lpa.com
W www.lpa.com

LPA
Architecture
Planning
Interior Design
Landscape Architecture
Graphics

Montgomery High School

Sweetwater Union High School District
3250 Palm Avenue, San Diego, CA 92154

Facility Needs Assessment and Master Plan

Montgomery High School
Sweetwater Union High School District

School Summary Break-out By Building

Summary By Category

#	Building	Area	Unit	Category					Total \$
				Modernization	Technology	ADA/Life Sfty	Reconfiguration	Augmentation	
A	Library	7,180	SF	\$560,009	\$52,430	\$38,468		\$582,744	\$1,233,651
B	Multi-Purpose	5,963	SF	\$744,029	\$100,024	\$194,093			\$1,038,146
C	Classroom	12,606	SF	\$1,246,327	\$244,401	\$130,712			\$1,621,440
D	Administration	4,806	SF	\$324,940	\$64,946	\$104,506	\$22,391	\$237,324	\$754,107
E	Counsel Center & Science	13,305	SF	\$1,823,052	\$223,435	\$503,326	\$8,426	\$92,952	\$2,651,191
F	Arts & Crafts	5,405	SF	\$509,633	\$75,214	\$336,520	\$57,049		\$978,416
G	Classrooms	12,609	SF	\$1,287,820	\$238,332	\$183,688	\$344,860		\$2,054,700
H	Shop & Band	9,274	SF	\$1,158,829	\$183,482	\$167,878	\$224,966		\$1,735,155
J	Men's & Women's Shower & Locker	11,218	SF	\$682,846	\$109,682	\$331,785		\$692,370	\$1,816,683
K	Gymnasium & Adaptive	16,833	SF	\$1,484,841	\$281,734	\$253,289	\$57,938		\$2,077,802
L	Classroom	7,203	SF	\$683,875	\$128,890	\$247,816			\$1,060,581
M	Music & Drama	4,357	SF	\$385,499	\$69,987	\$438,183			\$893,669
N	Media Studio & Classroom	10,393	SF	\$1,022,282	\$182,850	\$111,747			\$1,316,879
O	Concessions & Storage	1,260	SF	\$83,265	\$9,257	\$156,149			\$248,671
P	Ticket Booth	161	SF	\$10,242	\$496	\$10,204			\$20,942
Q	Storage		SF	Not Part Of Scope					
R	Dugout	560	SF	\$30,701	\$15,843	\$7,341			\$53,885
S	Storage		SF	Not Part Of Scope					
T	Announcer's Booth	211	SF	\$11,604	\$651	\$12,282			\$24,537
U	Storage		SF	Not Part Of Scope					
V	Relocatable Restroom		SF	\$7,291					\$7,291
1	Relocatable Classroom	9,003	SF	\$917,650	\$178,463	\$103,126	\$221,404		\$1,420,643
2	Relocatable Classrooms	1,800	SF	\$20,406					\$20,406
3	Relocatable Classrooms	11,254	SF	\$1,155,434	\$223,078	\$95,565			\$1,474,077
4	Relocatable Classrooms	960	SF	\$10,647					\$10,647
5	Relocatable Classrooms	1,920	SF	\$21,294					\$21,294
6	Relocatable Classrooms	4,800	SF	\$113,813					\$113,813
7	The Learning Center	5,404	SF	\$504,658	\$106,943	\$52,884	\$7,906		\$672,391
8	Security Residence		SF	Not Part Of Scope					
	Covered Walkways	56,530	SF	\$706,115				\$182,112	\$888,227
	Sitework	N/A	SF	\$10,195,288	\$1,204,757	\$1,534,598		\$491,453	\$13,426,096
	New Augmentation	20,500	SF					\$5,017,523	\$5,017,523
Totals		*AIA Area = 197,825	SF	\$25,702,390	\$3,694,895	\$5,014,160	\$944,940	\$7,296,478	\$42,652,863

Facility Needs Assessment - Preliminary Concept Plan

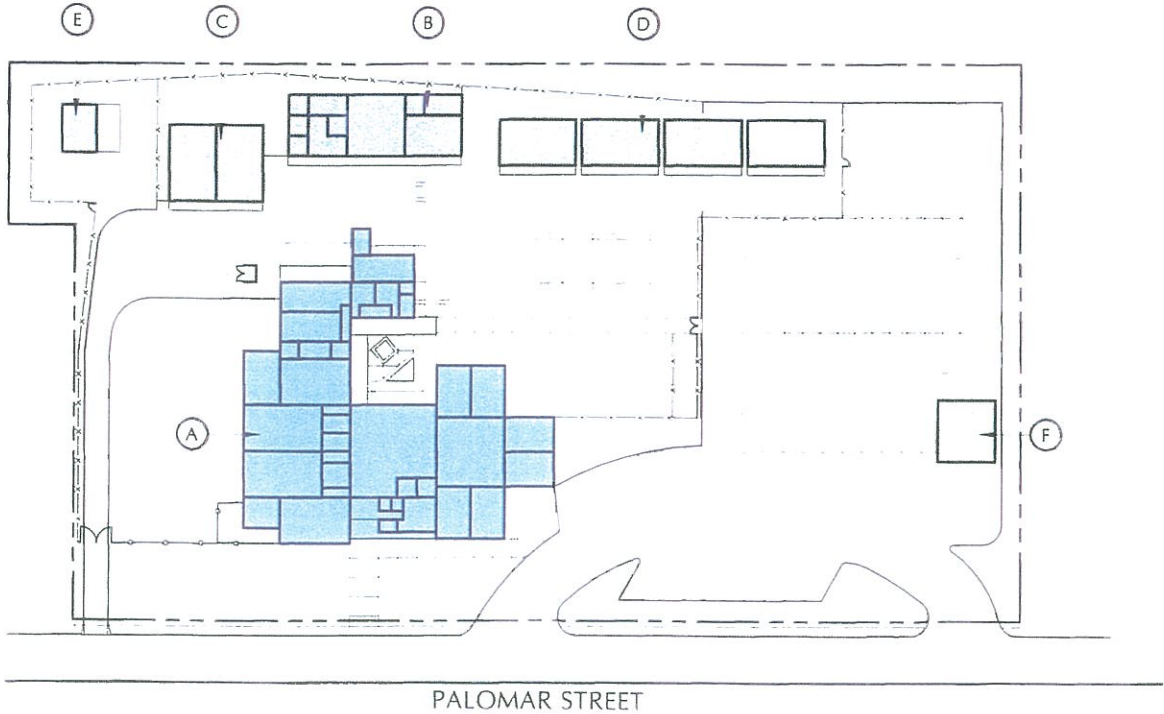

LEGEND

- Permanent Classroom
- ▲ Relocatable Classrooms
- Ⓢ Science Labs
- Special Ed Classrooms
- ▨ Support / Administration

Scope #1

- ▨ Modernization (60/40 State/District)
- Modernization (Remaining Measure BB Funds)
- Reconfiguration (Remaining Measure BB Funds)

Scope #2

- New Construction (50/50 State/District)

Scope #3

- Modernization/Expansion/ New Construction (100 % District)
- Reconfiguration (100 % District)
- Enhance Hardscape/Landscape

Facility Needs Assessment and Master Plan

Palomar High School
Sweetwater Union High School District

School Summary Break-out By Building

Summary By Category

#	Building	Area	Unit	Category					Total \$
				Modernization	Technology	ADA/Life Sfty	Reconfiguration	Augmentation	
	A Adminstration & Classroom	14,534	SF	\$1,367,200	\$215,249	\$373,472	\$50,180		\$2,006,101
	B Classroom/Counsel Center	3,083	SF	\$302,832	\$55,738	\$125,233			\$483,803
	C Relocatable Classroom	1,921	SF	\$200,044	\$38,072	\$17,188			\$255,304
	D Relocatable Classrooms	3,842	SF	\$391,139	\$76,144	\$37,928			\$505,211
	E Live-On	601	SF	\$72,336	\$11,469	\$8,930			\$92,735
	F Social Services	900	SF	\$83,053	\$11,469	\$13,227			\$107,749
	Covered Walkways	8,818	SF	\$54,846				\$182,112	\$236,958
	Sitework		SF	\$1,137,188	\$169,418	\$716,867		\$18,384	\$2,041,857
Totals		*AIA Area = 27,819	SF	\$3,608,638	\$577,559	\$1,292,845	\$50,180	\$200,496	\$5,729,718

Facility Needs Assessment - Preliminary Concept Plan

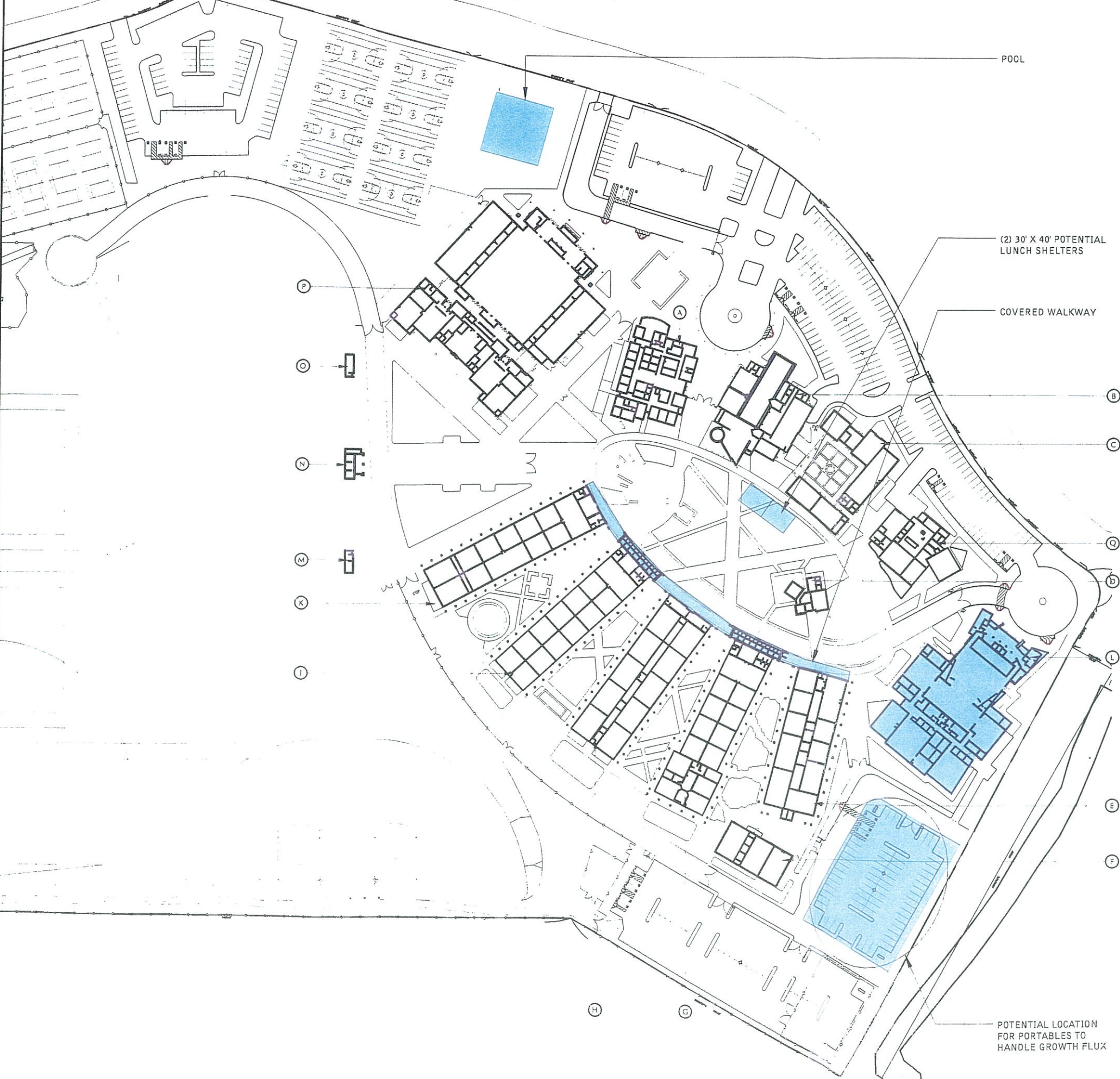

SUGGESTED FUTURE
ENROLLMENT = 2,800 students
Peak Enrollment = 3,784 - '09
Potential Boundary = pending further evaluation
Adjustment or Enrollment
Policy Change

LEGEND

- Permanent Classroom
- Relocatable Classrooms
- Science Labs
- Special Ed Classrooms
- Support / Administration
- Scope #1
 - Modernization (60/40 State/District)
 - Modernization (Remaining Measure BB Funds)
 - Reconfiguration (Remaining Measure BB Funds)
- Scope #2
 - New Construction (50/50 State/District)
- Scope #3
 - Modernization/Expansion/ New Construction (100 % District)
 - Reconfiguration (100% District)
 - Enhance Hardscape/Landscape

Facility Needs Assessment - Preliminary Concept Plan

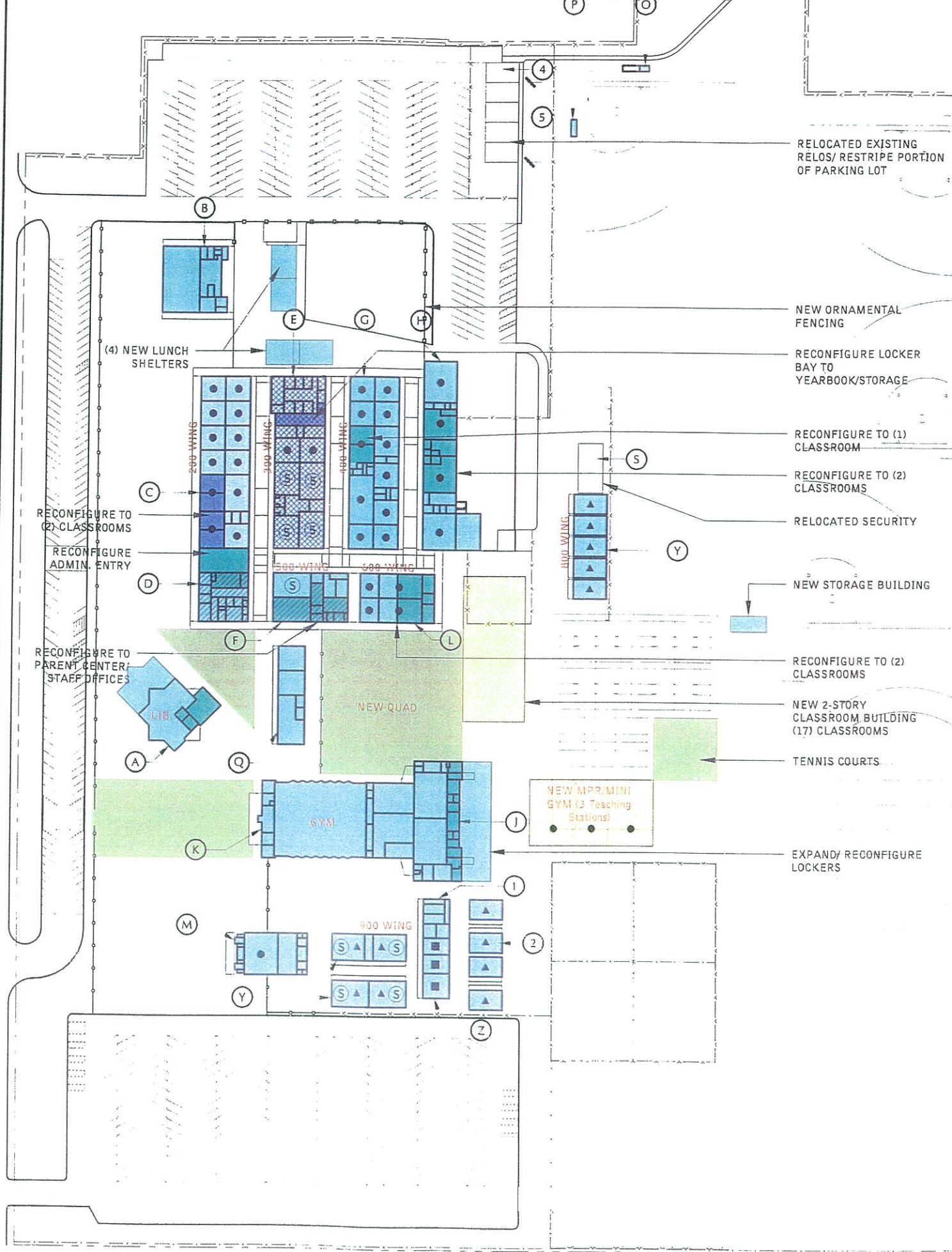

CBEDS 2001 = 2,558 students

SUGGESTED FUTURE ENROLLMENT = 2,070 students
 Maturity = 1,610
 Peak Enrollment = 2,229 @ '06
 Potential Boundary = None
 Adjustment or Enrollment Policy Change

CAPACITY W/ SPEC. ED. = 72(30)+3(13) S.E.
 = 2160+39 S.E.
 = 2199 Students

New Classroom Building Includes:
 (17) New classrooms, Staff & Student Restrooms & Staff Workroom
 (3) Multi-purpose/ Mini Gym Classroom

SPECIAL ED = 24/54 Students
 S/NS 2001 = 3 Classrooms @ 13 loading
 Teaching Stations = 72 Classrooms @ 30 loading
 Learning Center = 139 Students

LEGEND

- Permanent Classroom
- ▲ Relocatable Classrooms
- Ⓢ Science Labs
- Special Ed Classrooms
- ▨ Support / Administration

Scope #1

- ▨ Modernization (60/40 State/District)
- Modernization (Remaining Measure BB Funds)
- Reconfiguration (Remaining Measure BB Funds)

Scope #2

- New Construction (50/50 State/District)

Scope #3

- Modernization/Expansion/ New Construction (100 % District)
- Reconfiguration (100 % District)
- Enhance Hardscape/Landscape

Job No. 22037.10
 Filename SouthwestHSMP
 Date 08-13-03
 Scale 1" = 150'
 Sheet

17848 Sky Park Circle
 Irvine, California 92614
 P 949 | 261-1001
 F 949 | 260-1190
 E lpa@lpa-inc.com
 W www.lpa-inc.com

LPA
 Architecture
 Planning
 Interior Design
 Landscape Architecture
 Graphics

Southwest High School
 Sweetwater Union High School District
 1685 Hollister Street, San Diego, CA 92154

Facility Needs Assessment and Master Plan

Southwest High School
Sweetwater Union High School District

School Summary Break-out By Building

Summary By Category

#	Building	Area	Unit	Category					Total \$
				Modernization	Technology	ADA/Life Sfty	Reconfiguration	Augmentation	
A	Library	5,930	SF	\$544,854	\$52,430	\$45,286	\$72,797	\$279,232	\$994,599
B	Multi-Purpose	5,966	SF	\$670,481	\$100,024	\$209,504			\$980,009
C	Classroom	12,605	SF	\$1,087,604	\$184,176	\$273,246	\$34,155		\$1,579,181
D	Administration	3,606	SF	\$337,972	\$64,946	\$110,580	\$27,524		\$541,022
E	Classroom - Science	12,836	SF	\$1,640,326	\$208,203	\$542,507	\$16,688		\$2,407,724
F	Classroom - Arts & Crafts	5,405	SF	\$483,384	\$76,039	\$345,858	-\$182,036		\$723,245
G	Classrooms	12,609	SF	\$1,284,029	\$237,323	\$196,151	\$37,067		\$1,754,570
H	Shop & Band	9,276	SF	\$1,149,724	\$183,482	\$216,300	\$107,931		\$1,657,437
J	Men & Women Shower	11,545	SF	\$681,471	\$114,512	\$363,125	\$52,510	\$897,052	\$2,108,670
K	Gymnasium	16,838	SF	\$1,479,896	\$281,762	\$348,377			\$2,110,035
L	Classroom	5,405	SF	\$498,388	\$93,197	\$202,035	\$70,578		\$864,198
M	Drama	4,357	SF	\$385,493	\$69,987	\$130,854			\$586,334
N	Relocatable Classroom	3,841	SF	\$425,485	\$76,144	\$34,375			\$536,004
O	Storage & Dugout	225	SF	\$12,356	\$694	\$16,417			\$29,467
P	Dugout	140	SF	\$7,837	\$434	\$9,372			\$17,643
Q	The Learning Center	3,601	SF	\$357,855	\$71,295	\$32,227			\$461,377
R	Relocatable Classrooms		SF						
S	Security Resident (relo to be relocated)	1,200	SF	\$29,515					\$29,515
T	Storage	144	SF	\$4,706					\$4,706
U	Storage	200	SF	\$5,114					\$5,114
V	Relocatable Classrooms	960	SF	\$10,647					\$10,647
W	Relocatable Classrooms	3,840	SF	\$42,587					\$42,587
X	Relocatable Classrooms	11,520	SF	\$116,787					\$116,787
Y	Relocatable Classrooms - Science	5,401	SF	\$612,307	\$58,032	\$39,315			\$709,654
Z	Relocatable Classrooms	2,161	SF	\$236,866	\$42,831	\$19,336			\$299,033
1	Relocatable Restroom	721	SF	\$21,907		\$183,212			\$205,119
2	Relocatable Classrooms	4,801	SF	\$548,872	\$95,180	\$42,969			\$687,021
3	Relocatable Classrooms (relo)	960	SF	\$26,908					\$26,908
4	Nestor Family Resource Center (relo)	960	SF	\$26,908					\$26,908
5	Elementary School Relocatable (relo)	3,840	SF	\$59,438					\$59,438
	Covered Walkways	55,059	SF	\$685,914				\$182,112	\$868,026
	Sitework	N/A	SF	\$11,558,685	\$1,271,859	\$1,587,598		\$813,673	\$15,231,815
	New Augmentation	39,600	SF					\$9,208,011	\$9,208,011
Totals		*AIA Area = 208,844	SF	\$25,034,316	\$3,282,550	\$4,948,644	\$237,214	\$11,380,080	\$44,882,804

Facility Needs Assessment - Preliminary Concept Plan

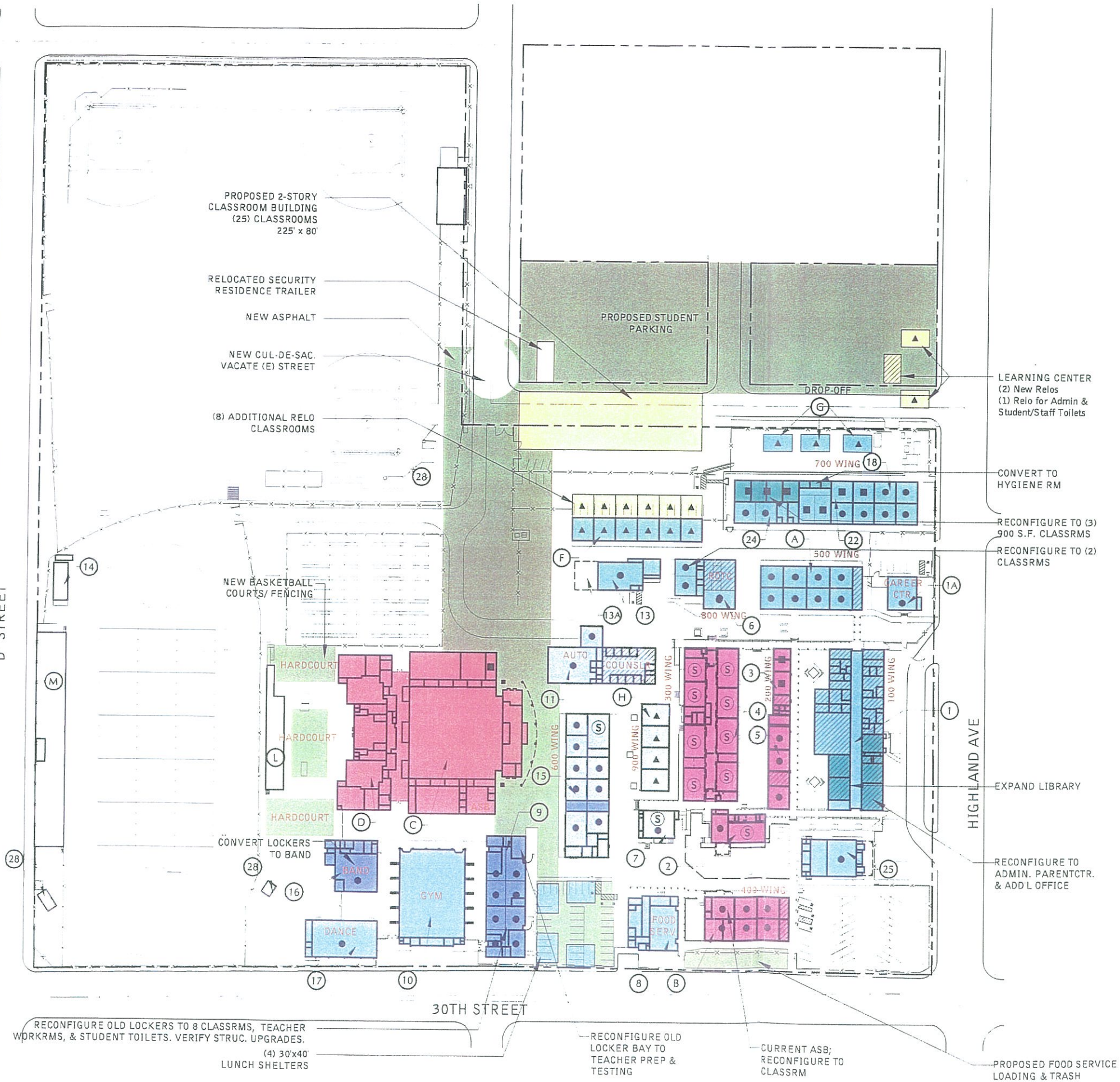

CBEDS 2001 = 2,883 students

SUGGESTED FUTURE
ENROLLMENT = 3,280 students
Maturity = 2,744 w/out boundary adjustments
Peak Enrollment = M.P. enrollment @ '08
Potential Boundary = None
Adjustment or
Enrollment Policy Change







CAPACITY W/
SPECIAL ED. 107(30)+10(13) S.E.
 =3210+130 S.E.
 =3340 Students

New Classroom Building Includes:



- (25) New Classrooms, Staff & Student Restrooms & Staff Workroom
- (6) New Relo Classrooms
- (2) New Relos for Learning Center
- (1) New Relo for Admin & Student/ Staff Toilets

SPECIAL ED = 42/89 Students
S/NS 2001 = 10 Classrooms @ 13 loading
Teaching Stations = 107 Classrooms @ 30 loading
Learning Center = 305 Students

LEGEND

-  Permanent Classroom
-  Relocatable Classrooms
-  Science Labs
-  Special Ed Classrooms
-  Support / Administration
-  Phase 1A (Complete 2002)
-  Phase 1B (Planning Complete)



Scope #1

-  Modernization (60/40 State/District)
 Modernization (Remaining Measure BB Funds)
 Reconfiguration (Remaining Measure BB Funds)

Scope #2

- ☐
- New Construction (50/50 State/District)

Scope #3

-  Modernization/Expansion/New Construction (100% District)
-  Reconfiguration (100% District)
-  Enhance Hardscape/Landscape

Facility Needs Assessment and Master Plan

Sweetwater High School
Sweetwater Union High School District

School Summary Break-out By Building

Summary By Category

#	Building	Area	Unit	Phase 1 A	Phase 1 B	Category					Total \$
				2002	2003	Modernization	Technology	ADA/Life Sfty	Reconfiguration	Augmentation	
1 Admin		16,224	SF			\$1,565,800	\$214,459	\$400,705	\$37,950	\$473,480	\$2,692,394
3 & 5 Classrooms		7,956	SF		\$837,805						
4 Classrooms		16,701	SF		\$2,640,510						
2 Classrooms		3,117	SF		\$599,631						
11 Shop		8,491	SF			\$934,459	\$151,910	\$92,447			\$1,178,816
7 Band		2,989	SF			\$526,355	\$59,649	\$86,413			\$672,417
17 Adaptive		4,975	SF			\$520,319	\$95,473	\$71,246			\$687,038
9 Locker		8,918	SF			\$893,436	\$138,308	\$260,313	\$127,758		\$1,419,815
6 Shop		4,993	SF			\$547,409	\$91,104	\$52,513			\$691,026
8 Cafeteria		5,050	SF			\$622,404	\$90,018	\$120,558			\$832,980
10 Gymnasium		11,358	SF			\$1,166,785	\$204,148	\$158,839			\$1,529,772
13 Shop		3,155	SF			\$331,392	\$46,405	\$84,092			\$461,889
1A Adult School Office		1,966	SF			\$214,515	\$37,507	\$20,416			\$272,438
13A Covered Shop Yard		736	SF			\$34,724					\$34,724
14 Restroom & Storage		573	SF			\$47,244	\$806	\$121,817			\$169,867
15 Classrooms		11,881	SF			\$1,302,833	\$132,122	\$450,893	\$22,276		\$1,908,124
16 Locker		4,572	SF			\$498,734	\$74,616	\$76,357	\$422,706		\$1,072,413
18 Classrooms		3,628	SF			\$438,215	\$71,940	\$31,572			\$541,727
22 Classrooms		3,600	SF			\$434,084	\$71,385	\$31,572	\$12,164		\$549,205
24 Classrooms		8,100	SF			\$808,512	\$133,811	\$263,799	\$65,232		\$1,271,354
25 Music & Drama		4,119	SF			\$668,218	\$85,662	\$68,517			\$822,3
27 Security			SF								
28 Misc. Out Buildings		1,282	SF			\$106,924	\$3,974	\$61,538			\$172,436
A Classrooms		6,570	SF			\$652,699	\$129,479	\$53,697			\$835,875
B Classrooms		7,170	SF		\$771,135						
C New Gymnasium			SF	Completed 2002							
D New shower & Locker			SF	Completed 2002							
E Relocatable Classrooms		960	SF			\$16,535					\$16,535
F Relocatable Classrooms		5,760	SF			\$613,157	\$89,231	\$45,652			\$748,040
G Relocatable Classrooms		2,880	SF			\$31,941					\$31,941
H Relocatable Classrooms		3,840	SF			\$471,818	\$76,144	\$39,822			\$587,784
J Relocatable Toilet		504	SF			\$5,590					\$5,590
K Relocatable Classrooms		2,880	SF			\$31,941					\$31,941
Covered Walkways		16,323	SF			\$166,738				\$182,112	\$348,850
Sitework		N/A	SF		\$535,864	\$6,036,645	\$984,284	\$1,154,210		\$67,173	\$8,242,312
Augmentation		44,640	SF							\$9,810,672	\$9,810,672
Totals		215,029	SF		\$5,384,945	\$19,689,425	\$2,982,435	\$3,746,988	\$688,086	\$10,533,437	\$37,640,370