



**Long Range Facilities Master Plan
(LRFMP)**

SECTION VII
Site Plan(s) / Budget
Summaries by School

Facility Needs Assessment - Preliminary Concept Plan



CBEDS 2001	= 1,277 students
SUGGESTED FUTURE ENROLLMENT	= 1,440 students
Maturity	= 1,040 students
Peak Enrollment	= 2003
Potential Boundary Adjustment or Enrollment Policy Change	= Shift 400 from RDR boundary

CAPACITY W/SPECIAL ED.	51(30)+7(13) S.E.
	=1530+91 S.E.
	=1621 Students

SPECIAL ED S/NS 2001	= 12/32 Students
Teaching Stations	= 7 classrooms @ 13 loading
	= 51 classrooms @ 30 loading

LEGEND

- Permanent Classroom
- Relocatable Classrooms
- Science Labs
- Special Ed Classrooms
- Support / Administration

Scope #1

- Modernization (60/40 State/District)
- Modernization (Remaining Measure BB Funds)
- Reconfiguration (Remaining Measure BB Funds)

Scope #2

- New Construction (50/50 State/District)

Scope #3

- Modernization/Expansion/ New Construction (100 % District)
- Reconfiguration (100% District)
- Enhance Hardscape/Landscape

Job No.	22037.10
Filename	Bonita Vista MS MP
Date	08-06-03
Scale	1" = 100'
Sheet	

17848 Sky Park Circle
Irvine, California 92614

P 9491 261-1001
F 9491 260-1190
E lpa@lpa-inc.com
W www.lpa-inc.com

LPA
Architecture
Planning
Interior Design
Landscape Architecture
Graphics

Facility Needs Assessment - Preliminary Concept Plan

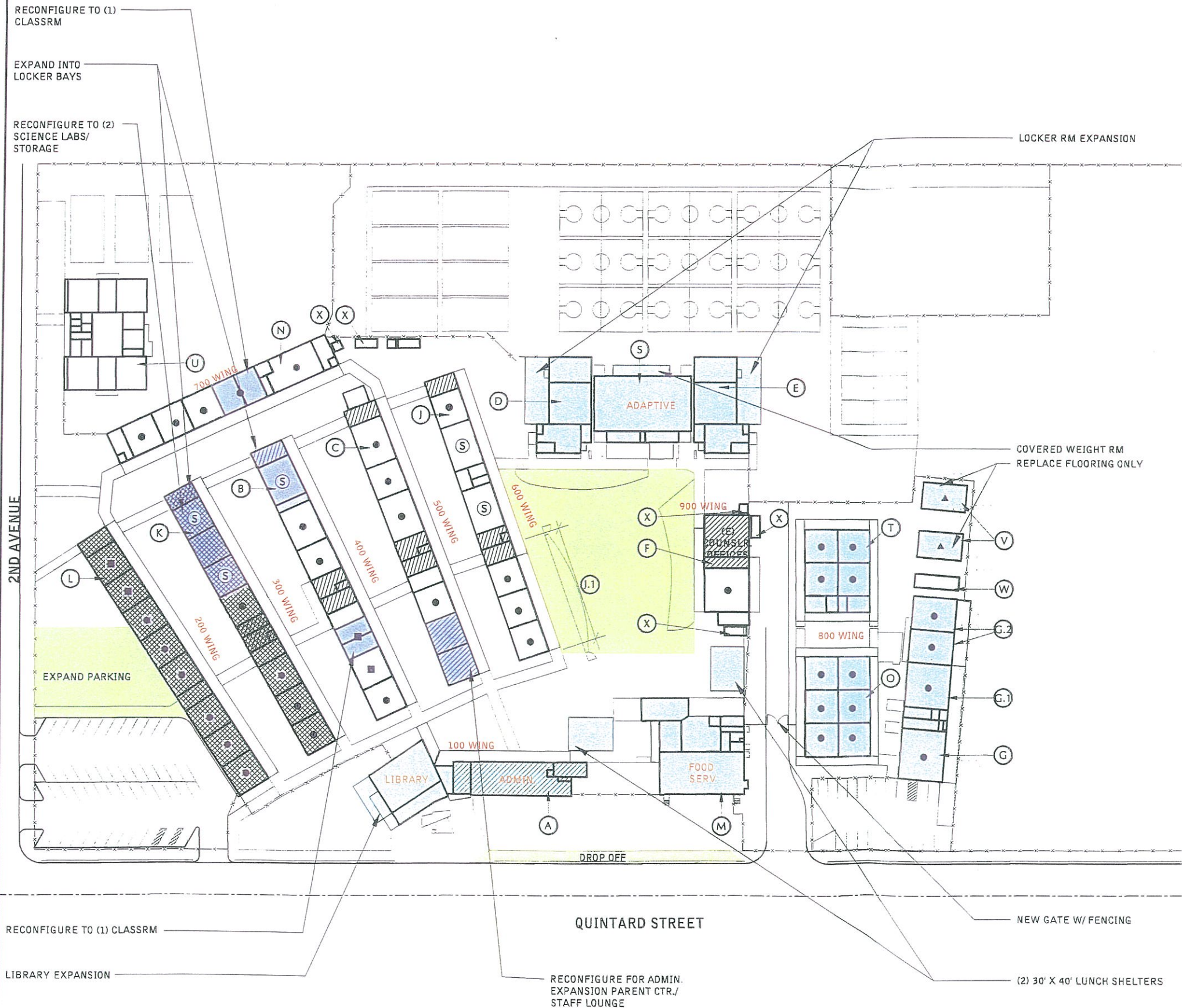

CBEDS 2001 = 1,463 students

SUGGESTED FUTURE ENROLLMENT = 1,400 students
Maturity = 1,516
Peak Enrollment = 2005. 1,787
Potential Boundary Adjustment or Enrollment Policy Change = Shift students to Hilltop M.S.

CAPACITY W/ SPECIAL ED. 48(30)+4(13) S.E.
=1440+52 S.E.
=1492 Students

SPECIAL ED = 1/44 Students
S/NS 2001 = 4 classrooms @ 13 loading
Teaching Stations = 48 classrooms @ 30 loading

LEGEND

- Permanent Classroom
- ▲ Relocatable Classrooms
- Ⓢ Science Labs
- Special Ed Classrooms
- ▨ Support / Administration

Scope #1

- ▨ Modernization (60/40 State/District)
- Modernization (Remaining Measure BB Funds)
- Reconfiguration (Remaining Measure BB Funds)

Scope #2

- New Construction (50/50 State/District)

Scope #3

- Modernization/Expansion/New Construction (100 % District)
- Reconfiguration (100% District)
- Enhance Hardscape/Landscape

Job No.	22037.10
Filename	CastleParkMSMP
Date	08-06-03
Scale	1" = 100'
Sheet	

17840 Sky Park Circle
Irvine, California 92614
P 949 263-1001
F 949 260-1190
E lpa@lpa.com
W www.lpac.com

LPA
Architecture
Planning
Interior Design
Landscape Architecture
Graphics

Castle Park Middle School
Westwater Union High School District
50 Quintard Street, Chula Vista, CA 91911

Facility Needs Assessment and Master Plan

Castle Park Middle School
Sweetwater Union High School District

School Summary Break-out By Building

Summary By Category

#	Building	Area	Unit	Category					Total \$
				Modernization	Technology	ADA/Life Sfty	Reconfiguration	Augmentation	
	A Administration	8,078	SF	\$554,392	\$88,585	\$40,807		\$327,794	\$1,011,578
	B Classroom	9,487	SF	\$933,855	\$149,370	\$202,834	\$163,304		\$1,449,363
	C Classroom	8,308	SF	\$768,289	\$145,553	\$180,792	\$22,770		\$1,117,404
	D Girl's Shower & Locker	4,728	SF	\$231,559	\$43,408	\$62,523		\$484,659	\$822,149
	E Boy's Shower & Locker	4,728	SF	\$225,976	\$43,408	\$62,523		\$484,659	\$816,566
	F Music	2,700	SF	\$565,647	\$76,386				\$642,033
	G Shop	2,201	SF	\$196,928	\$35,410	\$39,817			\$272,155
	G.1 Dance	2,000	SF	\$224,310	\$6,199	\$16,253			\$246,762
	G.2 Counseling	2,400	SF	\$281,444	\$53,128				\$334,572
	J Classroom	4,942	SF	\$461,288	\$78,572	\$125,275			\$665,135
	J.1 Classroom	2,520	SF	\$257,708	\$49,970				\$307,678
	K Classroom	7,456	SF	\$687,615	\$133,587	\$106,923	\$317,501		\$1,245,626
	L Classroom	8,100	SF	\$793,854	\$159,728	\$3,254			\$956,836
	M Cafeteria	5,998	SF	\$614,965	\$103,492	\$58,036			\$776,493
	N Classrooms	6,451	SF	\$619,001	\$105,395	\$192,202	-\$15,448		\$901,150
	O Classrooms	5,400	SF	\$538,143	\$107,078				\$645,221
	S Multi-Purpose	5,953	SF	\$456,245	\$131,568	\$6,739		\$159,804	\$754,356
	T Classrooms	4,500	SF	\$384,700	\$71,385	\$220,133			\$676,218
	U Activity Center		SF	Not A Part Of Scope					
	V Relocatable Classrooms		SF	\$21,374					\$21,374
	W Relocatable Restrooms		SF	Not A Part Of Scope					
	X Storage		SF	Not A Part Of Scope					
	Y Relocatable (Leased) Demo cost	2,880	SF	\$24,623					\$24,623
	Covered Walkways	31,691	SF	\$367,067				\$182,112	\$549,179
	Sitework		SF	\$3,733,372	\$666,209	\$802,945		\$438,487	\$5,641,013
Totals		*AIA Area = 109,394	SF	\$12,942,355	\$2,248,431	\$2,121,056	\$488,127	\$2,077,515	\$19,877,484

Facility Needs Assessment - Preliminary Concept Plan

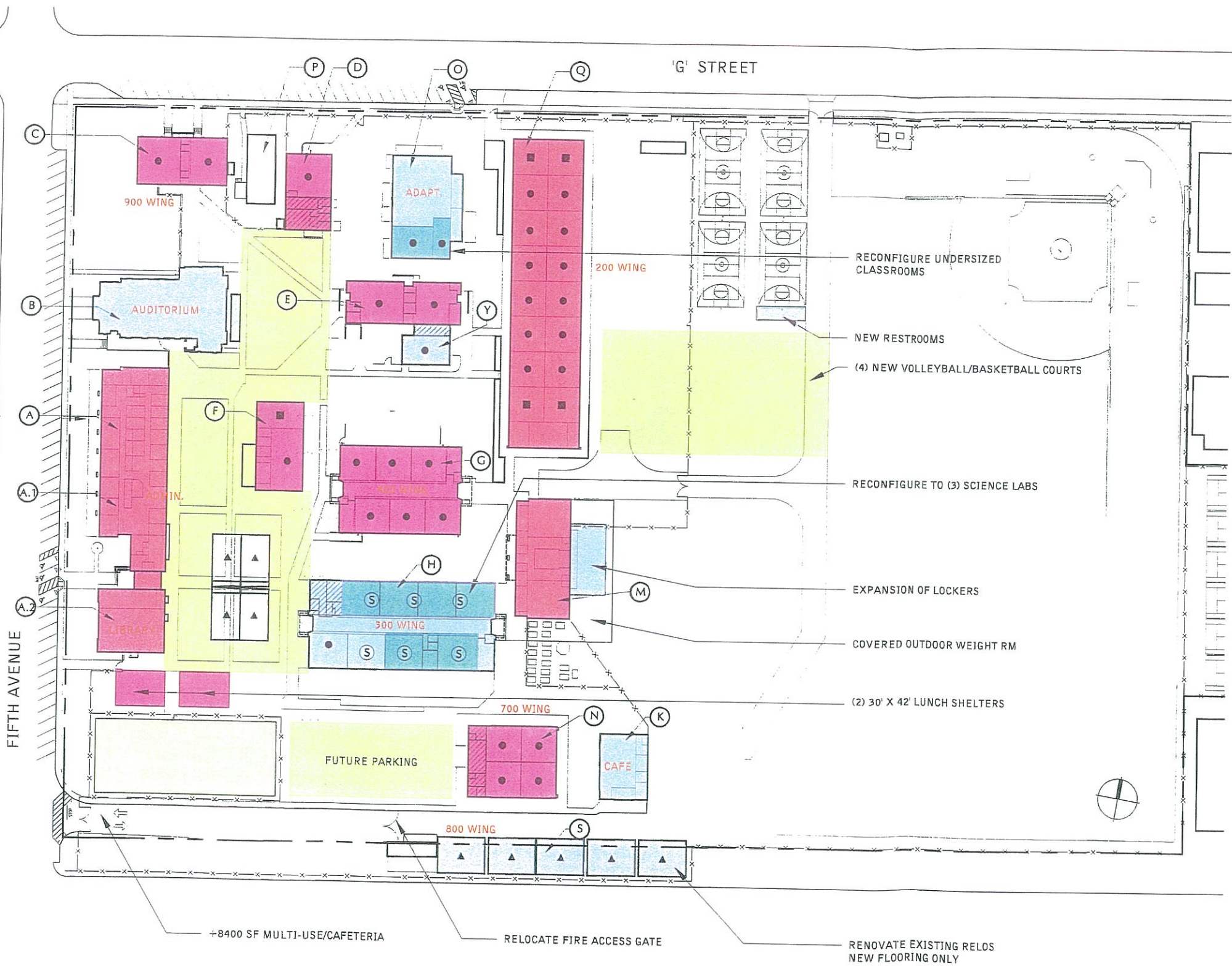

CBEDS 2001 = 1,347 students
Current Capacity = 1,410 students

SUGGESTED FUTURE
ENROLLMENT = 1,300 students
Maturity = 1319
Peak Enrollment = M.P. enrollment @ '08
Potential Boundary = None
Adjustment or Enrollment Policy Change

CAPACITY W/
SPECIAL ED. 47(30)+5(13) S.E.
=1410+65 S.E.
=1475 Students

SPECIAL ED
S/NS 2001 = 2/48 Students
Teaching Stations = 5 Classrooms @ 13 loading
= 47 Classrooms @ 30 loading

LEGEND

- Permanent Classroom
- ▲ Relocatable Classrooms
- Ⓢ Science Labs
- Special Ed Classrooms
- ▨ Support / Administration
- Phase 1A (Complete 2002)
- Phase 1B (Planning Complete)

Scope #1

- ▨ Modernization + Measure BB Funds
- Modernization (Remaining Measure BB Funds)
- ▨ Reconfiguration (Remaining Measure BB Funds)

Scope #2

- New Construction (Funding to be determined)

Scope #3

- ▨ Modernization/Expansion/New Construction (100 % District)
- ▨ Reconfiguration (100% District)
- ▨ Enhance Hardscape/Landscape

Job No.	22037.10
Filename	ChulaVistaMSMP
Date	08-06-03
Scale	1" = 100'
Sheet	

17844 Sky Park Circle
Irvine, California 92614

P 949 | 263-1001
F 949 | 260-1190
E lpa@lpainc.com
W www.lpainc.com

LPA

Architecture
Planning
Interior Design
Landscape Architecture
Graphics

Chula Vista Middle School

Sweetwater Union High School District
415 Fifth Avenue, Chula Vista, CA 91911

(C) Copyright 2003

Facility Needs Assessment and Master Plan

Chula Vista Middle School
Sweetwater Union High School District

School Summary Break-out By Building

Summary By Category

#	Building	Area	Unit	Phase 1 A	Phase 1 B	Category					Total \$
				2002	2003	Modernization	Technology	ADA/Life Sfty	reconfiguratio	Augmentation	
				Complete 2002							
A.1	Admin Renovation		SF	Complete 2002							
A.2	Library Renovation		SF	Complete 2002							
B	Auditorium	6,250	SF			\$584,659	\$135,990	\$138,067			\$858,716
C	Music	3,355	SF		\$864,662						
D	Drama	2,452	SF		\$419,480						
E	Boys' P.E.	4,675	SF		\$677,559						
F	Wood Shop	3,268	SF		\$532,142						
G	Classrooms	8,381	SF		\$1,216,765						
H	Classrooms / Science	12,508	SF			\$1,277,313	\$167,003	\$438,843	\$283,283		\$2,166,442
K	Cafeteria	2,521	SF			\$299,665	\$36,258	\$90,388	-\$21,434		\$404,877
L	Storage	336	SF			\$6,104					\$6,104
M	Girls' / Boys' Locker Room	4,570	SF	Complete 2002						\$1,017,449	\$1,017,449
N	Classrooms / Computers	4,569	SF		\$716,199						
O	Adaptive	5,167	SF			\$498,154	\$90,366	\$59,237	\$37,081		\$684,838
P	Security		SF	Complete 2002							
S	Relocatable Classrooms	4,800	SF			\$58,704					\$58,704
	Covered Walkways	9,312	SF			\$61,588				\$182,112	\$243,700
				Portion Complete 2002	Pending						
	Sitework	N/A	SF	Complete 2002	Pending	\$1,397,079	\$72,739	\$312,619		\$292,903	\$2,075,340
	Augmentation	12,000	SF							\$3,136,320	\$3,136,320
Totals		= 77,956	SF		\$4,426,807	\$4,183,266	\$502,356	\$1,039,154	\$298,931	\$4,628,784	\$10,652,491

Facility Needs Assessment - Preliminary Concept Plan

VAN NESS AVENUE

20th STREET

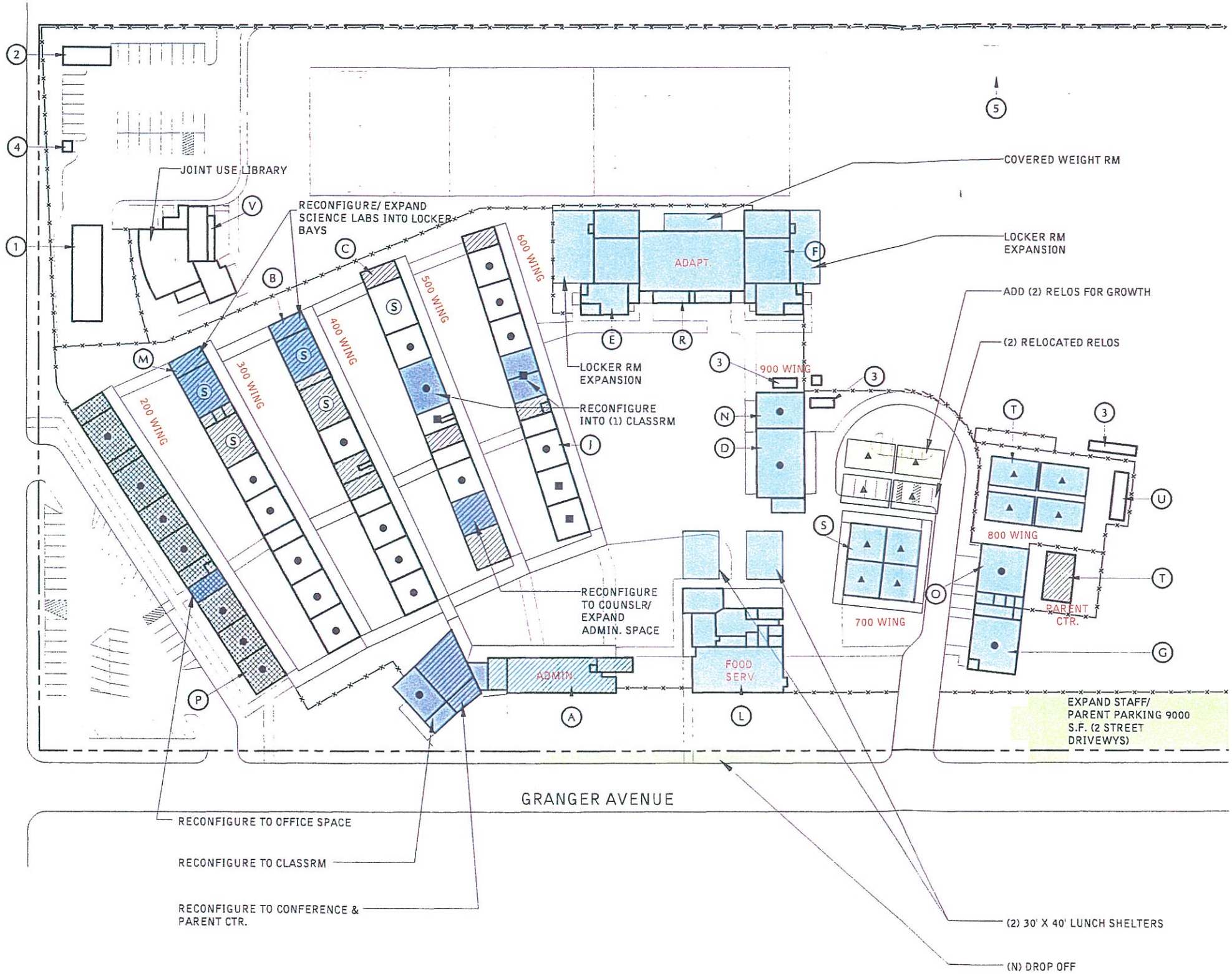

GRANGER AVENUE

CBEDS 2001 = 1,208 students

SUGGESTED FUTURE ENROLLMENT = 1,334 students
Maturity = 947 students
Peak Enrollment = 1348 students. 2008
Potential Boundary =
Adjustment or Enrollment Policy Change

CAPACITY W/ SPECIAL ED. = 45(30)+4(13) S.E. = 1350+52 S.E. = 1402 Students

SPECIAL ED S/NS 2001 Teaching Stations = 8/35 Students = 4 Classrooms @ 13 loading = 45 Classrooms @ 30 loading

LEGEND

- Permanent Classroom
- Relocatable Classrooms
- Science Labs
- Special Ed Classrooms
- Support / Administration

- Scope #1
- Modernization (60/40 State/District)
 - Modernization (Remaining Measure BB Funds)
 - Reconfiguration (Remaining Measure BB Funds)

- Scope #2
- New Construction (50/50 State/District)

- Scope #3
- Modernization/Expansion/New Construction (100 % District)
 - Reconfiguration (100% District)
 - Enhance Hardscape/Landscape

Job No.	22037.10
Filename	GrangerJHSM
Date	08-06-03
Scale	1" = 100'
Sheet	

17048 Sky Park Circle
Irvine, California 92614

P 949 | 261-1001
F 949 | 260-1190
E lpa@lpa-inc.com
W www.lpa-inc.com

LPA
Architecture
Planning
Interior Design
Landscape Architecture
Graphics

Facility Needs Assessment - Preliminary Concept Plan

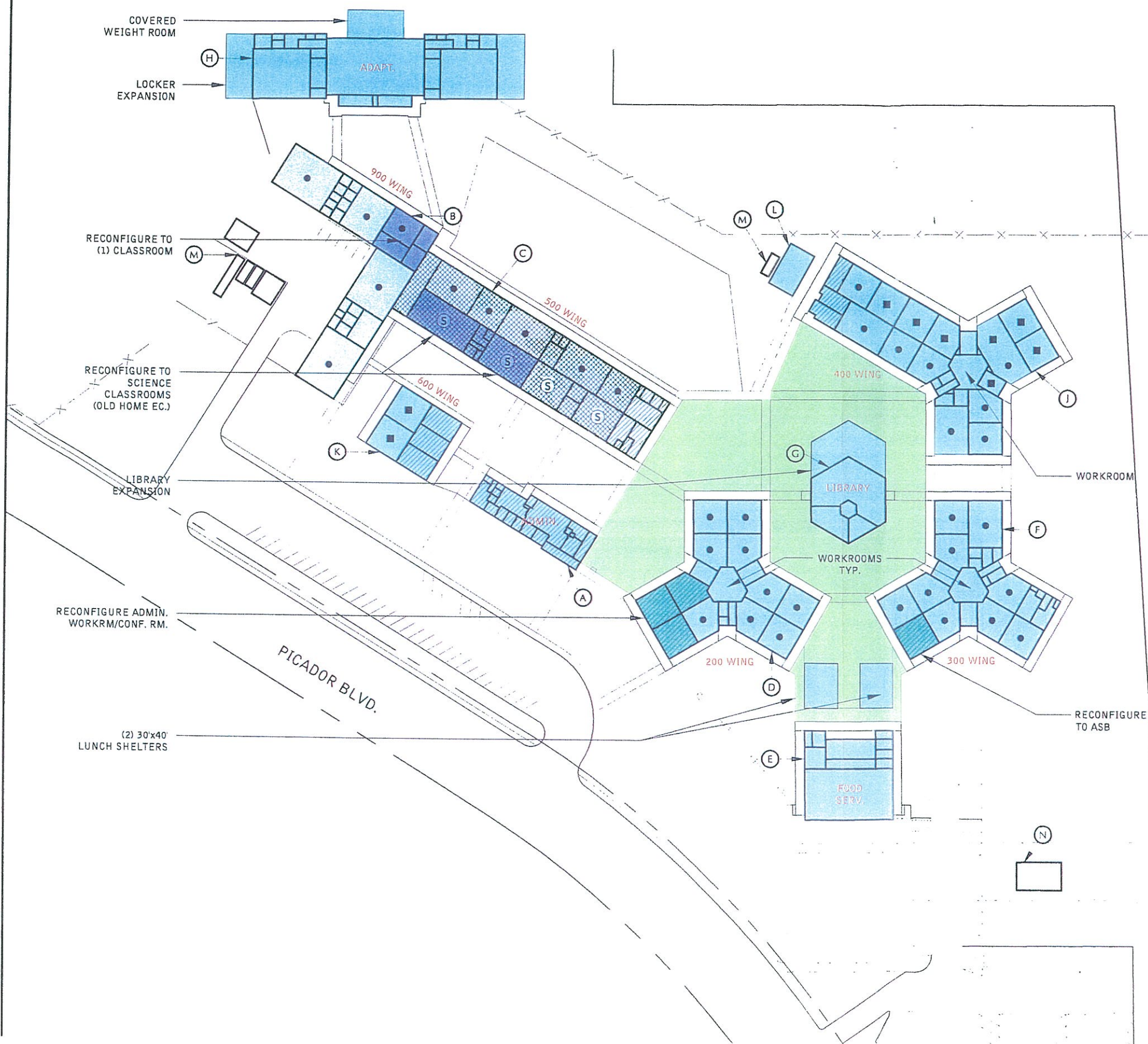

CBEDS 2001 = 1,204 students

SUGGESTED FUTURE ENROLLMENT = 1,099 students
Maturity = 738 students
Peak Enrollment = 2008
Potential Boundary = None
Adjustment or Enrollment Policy Change

CAPACITY W/ SPEC. ED. = 40(30)+9(13) S.E. = 1200+117 S.E. = 1317 Students

SPECIAL ED S/NS 2001 = 37/62 Students
Teaching Stations = 9 Classrooms @ 13 loading = 40 Classrooms @ 30 loading

LEGEND

- Permanent Classroom
- ▲ Relocatable Classrooms
- Ⓢ Science Labs
- Special Ed Classrooms
- ▨ Support / Administration

Scope #1

- ▨ Modernization (60/40 State/District)
- Modernization (Remaining Measure BB Funds)
- Reconfiguration (Remaining Measure BB Funds)

Scope #2

- New Construction (50/50 State/District)

Scope #3

- Modernization/Expansion/ New Construction (100 % District)
- Reconfiguration (100% District)
- Enhance Hardscape/Landscape

Job No.	22037.10
Filename	MontgomeryMSMP
Date	08-06-03
Scale	1" = 100'
Sheet	

17848 Sky Park Circle
Irvine, California 92614

P 9491 261-1001
F 9491 260-1190
E lpa@lpa.com
W www.lpa.com

LPA
Architecture
Planning
Interior Design
Landscape Architecture
Graphics

Montgomery Middle School

Sweetwater Union High School District
1051 Picador Blvd., San Diego, CA 92154

Facility Needs Assessment and Master Plan

Mar Vista Middle School
Sweetwater Union High School District

School Summary Break-out By Building

Summary By Category

#	Building	Area	Unit	Category					Total \$
				Modernization	Technology	ADA/Life Sfty	Reconfiguration	Augmentation	
	A Cafeteria	5,966	SF	\$726,197	\$105,487	\$131,711			\$963,395
	B Administration	2,884	SF	\$281,772	\$47,499	\$98,360			\$427,631
	C Library	4,794	SF	\$345,564	\$35,913	\$41,090	\$49,156	\$373,685	\$845,408
	D Music / Admin	3,704	SF	\$860,445	\$101,176	\$99,973			\$1,061,594
	E.1 Science/Technology	2,402	SF	\$463,182	\$49,377	\$57,358			\$569,917
	E.2 Shop	6,135	SF	\$1,130,752	\$120,858	\$91,092			\$1,342,702
	F Girl's Shower & Locker	4,356	SF	\$277,397	\$44,319	\$137,187		\$311,567	\$770,470
	G Boy's Shower & Locker	4,356	SF	\$276,970	\$44,254	\$141,451		\$311,567	\$774,242
	H Classroom	7,142	SF	\$836,800	\$133,096	\$108,469	\$10,626		\$1,088,991
	J Classroom	7,144	SF	\$803,385	\$119,688	\$178,922	\$43,643		\$1,145,638
	K Classroom	7,144	SF	\$891,015	\$129,654	\$223,465	\$467,462		\$1,711,596
	L Classroom	7,145	SF	\$752,042	\$117,012	\$280,717			\$1,149,771
	M Classroom	8,044	SF	\$878,024	\$138,812	\$249,763			\$1,266,599
	N Classroom	8,045	SF	\$856,192	\$142,147	\$260,716			\$1,259,055
	P Multipurpose	6,155	SF	\$461,656	\$89,723	\$78,613		\$195,316	\$825,308
	R Security Residence		SF	Not Part Of Scope					
	S Storage		SF	Not Part Of Scope					
	T After School Activity Program	960	SF	\$20,214					\$20,214
	U Classroom	5,400	SF	\$590,455	\$107,078	\$51,563			\$749,096
	V Relocatable Classroom	5,760	SF						
	W Relocatable Classroom	1,920	SF						
	X Relocatable Faculty Toilet		SF	Not Part Of Scope					
	Y Relocatable Classroom (Leased)		SF						
	Covered Walkways	31,407	SF	\$363,180				\$182,112	\$545,292
	Sitework		SF	\$5,326,939	\$669,436	\$805,495		\$645,189	\$7,447,059
	Totals	*AIA Area = 109,924	SF	\$16,142,181	\$2,195,529	\$3,035,945	\$570,887	\$2,019,436	\$23,963,978

Facility Needs Assessment - Preliminary Concept Plan

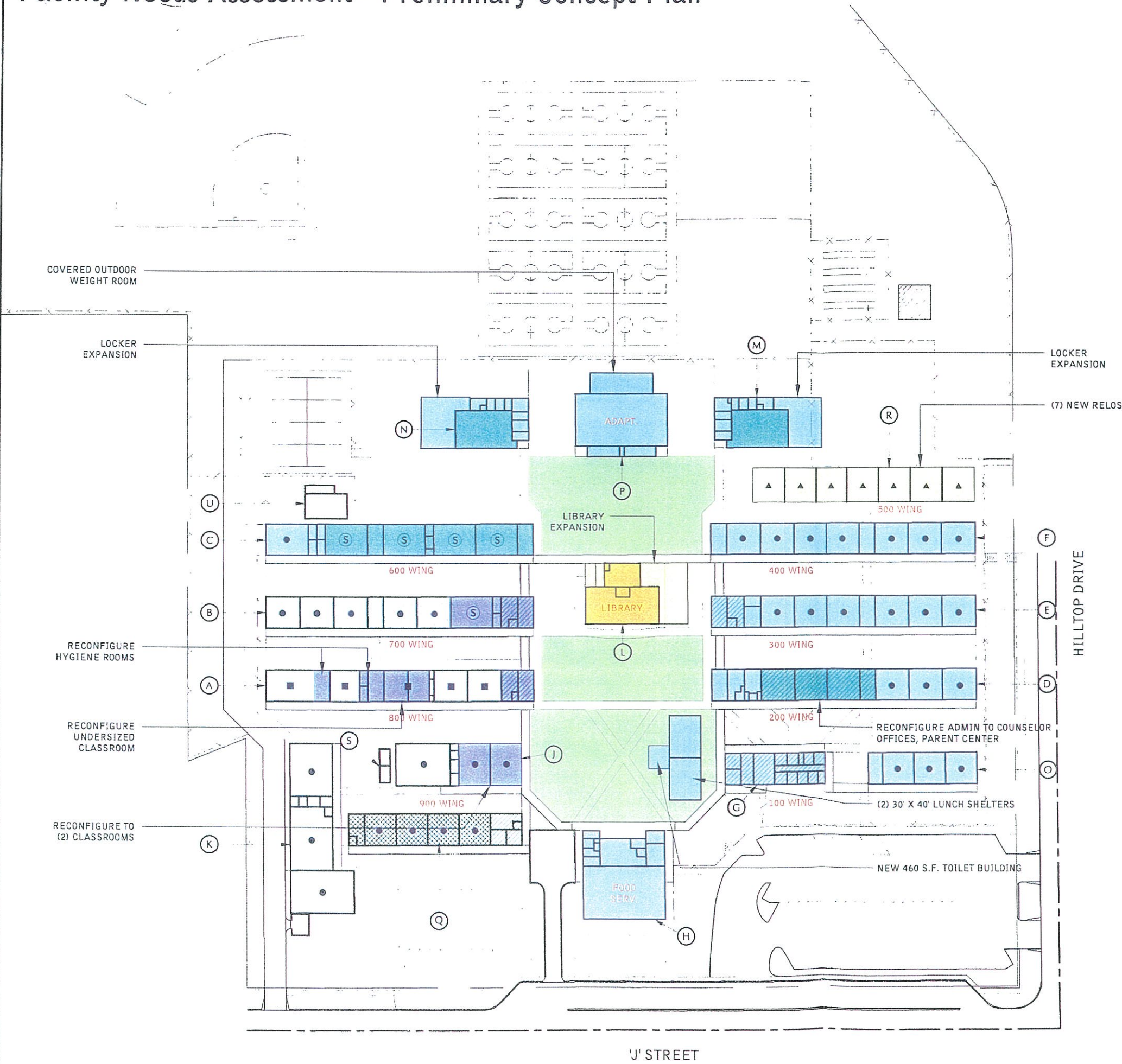

CBEDS 2001 = 1,208 students

SUGGESTED FUTURE
ENROLLMENT = 1,448 students
Maturity = 1,319 students
Peak Enrollment =
Potential Boundary = between CVMS and CPMS
Adjustment or Enrollment Policy Change

CAPACITY W/
SPECIAL ED. = 47(30)+5(13) S.E.
=1410+65 S.E.
=1475 Students

SPECIAL ED
S/NS 2001 = 8/35 Students
Teaching Stations = 5 Classrooms @ 13 loading
= 47 Classrooms @ 30 loading

LEGEND

- Permanent Classroom
- Relocatable Classrooms
- Science Labs
- Special Ed Classrooms
- Support / Administration

Scope #1

- Modernization (60/40 State/District)
- Modernization (Remaining Measure BB Funds)
- Reconfiguration (Remaining Measure BB Funds)

Scope #2

- New Construction (50/50 State/District)
- Reconfiguration/ Modernization

Scope #3

- Modernization/Expansion/ New Construction (100 % District)
- Reconfiguration (100% District)
- Enhance Hardscape/Landscape

Job. No.	22037.10
Filename	HilltopMSMP
Date	08-06-03
Scale	1" = 100'
Sheet	

17546 Sky Park Circle
Irvine, California 92614

P 949 | 263-1001
F 949 | 260-1190
E lpa@lpainc.com
W www.lpainc.com

LPA
Architecture
Planning
Interior Design
Landscape Architecture
Graphics

Hilltop Middle School

Sweetwater Union High School District
44 East J' Street, Chula Vista, CA 91910

Facility Needs Assessment and Master Plan

Hilltop Middle School
Sweetwater Union High School District

School Summary Break-out By Building

Summary By Category

#	Building	Area	Unit	Category					Total \$
				Modernization	Technology	ADA/Life Sfty	Reconfiguration	Augmentation	
	A Classroom	8,557	SF	\$864,769	\$120,863	\$643,094	\$176,945		\$1,805,671
	B Classroom	7,625	SF	\$819,818	\$122,742	\$241,061	\$82,680		\$1,266,301
	C Classroom	7,625	SF	\$1,096,384	\$126,523	\$158,024	\$655,430		\$2,036,361
	D Classroom	7,625	SF	\$795,445	\$123,337	\$247,854	\$116,802		\$1,283,438
	E Classroom	7,621	SF	\$720,323	\$118,494	\$180,325			\$1,019,142
	F Classrooms	7,621	SF	\$829,684	\$136,042	\$42,969			\$1,008,695
	G Adminstration	2,886	SF	\$292,621	\$54,944	\$67,836			\$415,401
	H Cafeteria	6,163	SF	\$818,820	\$52,760	\$290,439			\$1,162,019
	J Music	4,803	SF	\$781,177	\$111,988	\$69,681	\$57,766		\$1,020,612
	K Shop/Technology	7,205	SF	\$753,746	\$129,442	\$161,308			\$1,044,496
	L Library	5,923	SF	\$338,544	\$35,733	\$39,107		\$643,447	\$1,056,831
	M Girl's Shower & Locker	5,424	SF	\$283,964	\$50,856	\$169,083	\$47,500	\$461,580	\$1,012,983
	N Boy's Shower & Locker	5,225	SF	\$277,565	\$54,411	\$149,171	\$47,500	\$467,350	\$995,997
	O Classrooms	3,111	SF	\$333,812	\$54,810	\$60,011			\$448,633
	P Adaptive	5,056	SF	\$469,415	\$94,489	\$69,829		\$223,726	\$857,459
	Q Classrooms	6,211	SF	\$431,263	\$73,183	\$246,820			\$751,266
	R Relocatable Classrooms	3,840	SF	\$38,929					\$38,929
	S Storage		SF	Not A Part Of Scope					
	T Storage	160	SF	\$4,823					\$4,823
	U Security Residence		SF	Not A Part Of Scope					
	Covered Walkways	33,521	SF	\$424,801				\$91,056	\$515,857
	Sitework		SF	\$5,017,081	\$734,293	\$856,719		\$749,372	\$7,357,465
	Augmentation	6,720	SF					\$1,427,711	\$1,427,711
Totals		*AIA Area = 120,573	SF	\$15,392,984	\$2,194,910	\$3,693,331	\$1,184,623	\$4,064,242	\$26,530,090

Facility Needs Assessment - Preliminary Concept Plan

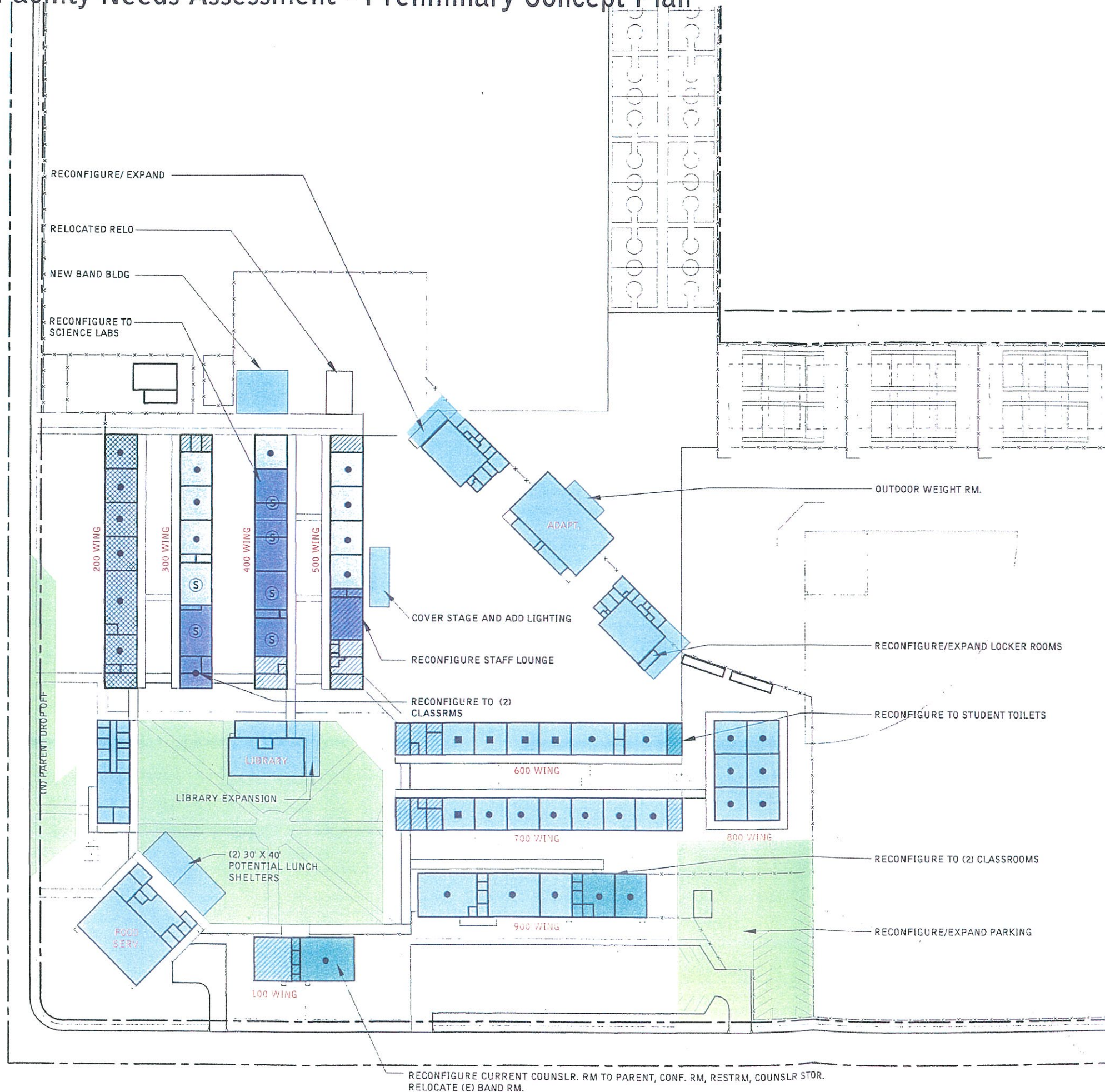

CBEDS 2001 = 1,369 students

SUGGESTED FUTURE
 ENROLLMENT = 1,140 students
 Maturity = 1,284 students
 Peak Enrollment = 1,543 in 2002
 Potential Boundary = None
 Adjustment or Enrollment Policy Change

CAPACITY W/
 SPECIAL ED. = 41(30)+5(13) S.E.
 = 1230 + 65 S.E.
 = 1295 Students

SPECIAL ED
 S/NS 2001 = 8/53 Students or 5 rooms
 Teaching Stations = 5 Classrooms @ 13 loading
 = 41 Classrooms @ 30 loading

LEGEND

- Permanent Classroom
- ▲ Relocatable Classrooms
- Ⓢ Science Labs
- Special Ed Classrooms
- ▨ Support / Administration

Scope #1

- ▨ Modernization (60/40 State/District)
- Modernization (Remaining Measure BB Funds)
- Reconfiguration (Remaining Measure BB Funds)

Scope #2

- New Construction (50/50 State/District)

Scope #3

- Modernization/Expansion/New Construction (100 % District)
- Reconfiguration (100 % District)
- Enhance Hardscape/Landscape

Job No.	22037.10
Filename	MarVistaMSMP
Date	08-06-03
Scale	1" = 100'
Sheet	

17848 Sky Park Circle
 Irvine, California 92614

P 949 | 261-1001
 F 949 | 260-1190
 E lpa@lpainc.com
 W www.lpainc.com

LPA
 Architecture
 Planning
 Interior Design
 Landscape Architecture
 Graphics

Mar Vista Middle School

Sweetwater Union High School District
 1267 Thermal Avenue, San Diego, CA 92154

Facility Needs Assessment and Master Plan

Montgomery Middle School
Sweetwater Union High School District

School Summary Break-out By Building

Summary By Category

#	Building	Area	Unit	Category					Total \$
				Modernization	Technology	ADA/Life Sfty	Reconfiguration	Augmentation	
	A Adminstration	3,112	SF	\$315,044	\$55,065	\$117,281			\$487,390
	B Music & Shop	11,409	SF	\$1,353,721	\$215,527	\$346,480	\$47,052		\$1,962,780
	C Home Ec - Arts & Science	15,315	SF	\$1,733,166	\$259,314	\$563,527	\$345,258		\$2,901,265
	D Classroom	12,262	SF	\$1,277,769	\$229,893	\$162,558	\$33,497		\$1,703,717
	E Multi-Purpose	5,961	SF	\$658,704	\$100,803	\$198,840			\$958,347
	F Classroom	12,271	SF	\$1,189,593	\$208,345	\$388,909	\$11,385		\$1,798,232
	G Library	5,553	SF	\$396,083	\$205,306	\$97,505	\$47,786	\$388,496	\$1,135,176
	H Gym & Locker	15,965	SF	\$1,067,984	\$200,345	\$411,762		\$754,535	\$2,434,626
	J Classroom	16,470	SF	\$1,679,719	\$282,234	\$416,612			\$2,378,565
	K Relocatable Classrooms	3,863	SF	\$421,053	\$76,600	\$24,898			\$522,551
	L Relocatable Classrooms	960	SF	\$12,022					\$12,022
	M Storage / ASB	1,280	SF	\$12,976					\$12,976
	N Security Residence		SF	Not Part Of Scope					
	Covered Walkways	31,810	SF	\$368,689				\$182,112	\$550,801
	Sitework		SF	\$5,784,477	\$700,496	\$830,027		\$573,538	\$7,888,538
Totals		*AIA Area = 115,024	SF	\$16,271,000	\$2,533,928	\$3,558,399	\$484,978	\$1,898,681	\$24,746,986

Facility Needs Assessment and Master Plan

Granger Junior High School
Sweetwater Union High School District

School Summary Break-out By Building

Summary By Category

#	Building	Area	Unit	Category					Total \$
				Modernization	Technology	ADA/Life Sfty	Reconfiguration	Augmentation	
	A Administration	6,714	SF	\$441,533	\$60,675	\$139,096	\$39,848		\$681,152
	B Classroom	9,491	SF	\$967,857	\$149,370	\$296,622	\$59,686		\$1,473,535
	C Classroom	7,995	SF	\$800,194	\$144,561	\$280,821	\$28,944		\$1,254,520
	D Music	2,323	SF	\$507,928	\$65,636	\$60,446			\$634,010
	E Girl's Shower & Locker	5,550	SF	\$324,895	\$59,886	\$138,689		\$470,812	\$994,282
	F Boy's Shower & Locker	5,260	SF	\$336,037	\$59,886	\$138,689		\$403,883	\$938,495
	G Dance	2,202	SF	\$217,453	\$35,410	\$66,632			\$319,495
	J Classroom	7,465	SF	\$737,808	\$138,969	\$172,972	\$14,611		\$1,064,360
	L Multi-Purpose	5,919	SF	\$678,046	\$101,868	\$183,157			\$963,071
	M Classroom	8,283	SF	\$862,462	\$156,655	\$104,256	\$150,510		\$1,273,883
	N Music	1,201	SF	\$267,710	\$33,950	\$22,579			\$324,239
	O Band	1,893	SF	\$193,697	\$31,587	\$70,488			\$295,772
	P Classroom	8,434	SF	\$843,840	\$150,926	\$211,957	\$7,088		\$1,213,811
	R Adaptive (Gym)	6,487	SF	\$519,948	\$89,723	\$199,049		\$253,023	\$1,061,743
	S Classroom - Computer	3,601	SF	\$380,499	\$71,385	\$34,375			\$486,259
	T Relocatable Classrooms	4,800	SF	\$53,581					\$53,581
	U Relocatable Restroom		SF	Not Part Of Scope					
	V Library (Joint Use)		SF	Not Part Of Scope					
	1 Security Residence		SF	Not Part Of Scope					
	2 Pump House	600	SF	\$52,650	\$1,860	\$28,493			\$83,0'
	3 Storage		SF	Not Part Of Scope					
	4 Trash Enclosure		SF	Not Part Of Scope					
	Covered Walkways	30,612	SF	\$385,087				\$91,056	\$476,143
	Sitework		SF	\$4,027,786	\$599,385	\$750,168		\$758,247	\$6,135,586
Totals		*AIA Area = 98,421	SF	\$12,599,011	\$1,951,732	\$2,898,489	\$300,687	\$1,977,021	\$19,726,940

Facility Needs Assessment - Preliminary Concept Plan

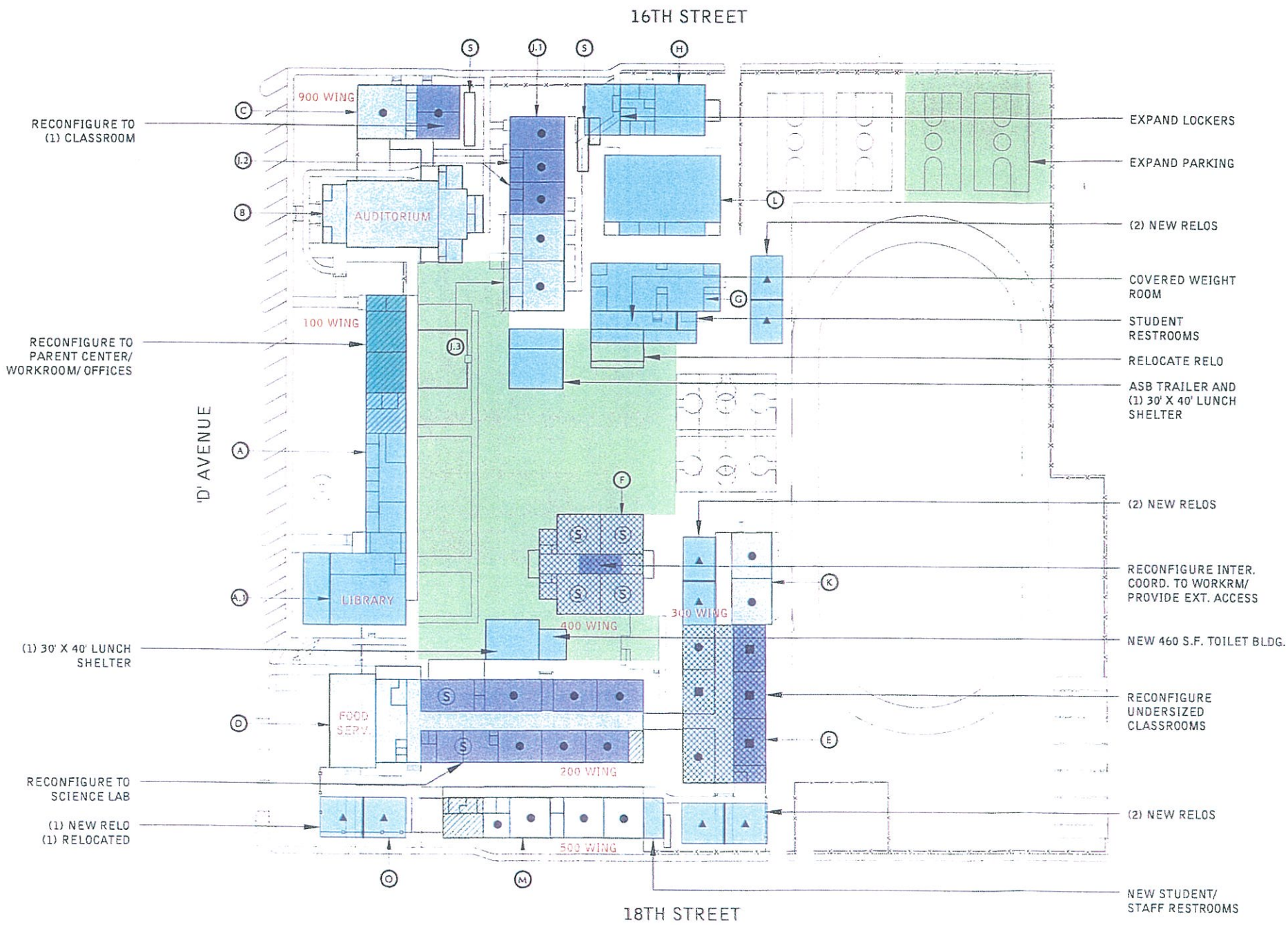

CBEDS 2001 = 934 students

SUGGESTED FUTURE
ENROLLMENT = 1,047 students
Maturity = 738
Peak Enrollment = Now
Potential Boundary = None
Adjustment or Enrollment Policy Change

CAPACITY W/ SPECIAL ED.
= 35(30)+4(13)
= 1050+52
= 1102 Students

SPECIAL ED
S/NS 2001 = 2/40 Students
= 4 Classrooms
Teaching Stations = 35 Classrooms

LEGEND

- Permanent Classroom
- Relocatable Classrooms
- Science Labs
- Special Ed Classrooms
- Support / Administration

Scope #1

- Modernization (60/40 State/District)
- Modernization (Remaining Measure BB Funds)
- Reconfiguration (Remaining Measure BB Funds)

Scope #2

- New Construction (50/50 State/District)

Scope #3

- Modernization/Expansion/ New Construction (100 % District)
- Reconfiguration (100 % District)
- Enhance Hardscape/Landscape

Facility Needs Assessment and Master Plan

National City Middle School
Sweetwater Union High School District

School Summary Break-out By Building

Summary By Category

#	Building	Area	Unit	Category					Total \$
				Modernization	Technology	ADA/Life Sfty	Reconfiguration	Augmentation	
	A Administration	5,840	SF	\$661,710	\$105,964	\$64,070	\$39,848		\$871,592
	A.1 Library	5,519	SF	\$412,503	\$32,780	\$64,686		\$594,885	\$1,104,854
	B Assembly	6,446	SF	\$690,781	\$93,414	\$212,766			\$996,961
	C Music	3,251	SF	\$668,486	\$83,803	\$54,267	\$52,280		\$858,836
	D Science/Cafeteria	14,835	SF	\$1,597,121	\$217,648	\$278,787	\$494,776		\$2,588,332
	E Classroom	7,320	SF	\$747,481	\$106,831	\$137,533	\$117,630		\$1,109,475
	F Classroom	5,556	SF	\$547,217	\$80,961	\$158,176	\$24,115		\$810,469
	G Girl's Shower & Locker	3,532	SF	\$327,367	\$59,341	\$119,350			\$506,058
	H Boy's Shower & Locker	5,292	SF	\$190,546	\$30,206	\$115,688		\$403,883	\$740,323
	J.1 Shop Building	1,013	SF	\$116,237	\$19,255	\$12,757	\$15,955		\$164,204
	J.2 Shop	2,027	SF	\$230,670	\$38,510	\$25,514	\$31,894		\$326,588
	J.3 Classroom	2,878	SF	\$324,222	\$57,019	\$28,706			\$409,947
	K Classroom	2,074	SF	\$300,249	\$41,046	\$61,220			\$402,515
	L Gym/Adaptive	7,055	SF	\$455,859	\$89,723	\$60,681		\$355,120	\$961,383
	M Classrooms	6,102	SF	\$562,859	\$91,202	\$123,867		\$388,496	\$1,166,424
	N Relocatable Restroom (demo)	480	SF	\$7,152					\$7,152
	O Relo Classrooms (relocate)	960	SF	\$25,800					\$25,800
	P Relo Classrooms (demo)	960	SF	\$12,758					\$12,758
	Q Relocatable Restroom (demo)	480	SF	\$7,152					\$7,152
	S Storage		SF	Not Part Of Scope					
	Covered Walkways	16,828	SF	\$164,182				\$182,112	\$346,294
	Sitework	N/A	SF	\$1,852,339	\$560,437	\$719,406		\$998,457	\$4,130,639
	Augmentation	4,800	SF					\$1,019,794	\$1,019,794
Totals		*AIA Area = 92,026	SF	\$9,902,691	\$1,708,140	\$2,237,474	\$776,498	\$3,942,747	\$18,567,549

Facility Needs Assessment - Preliminary Concept Plan

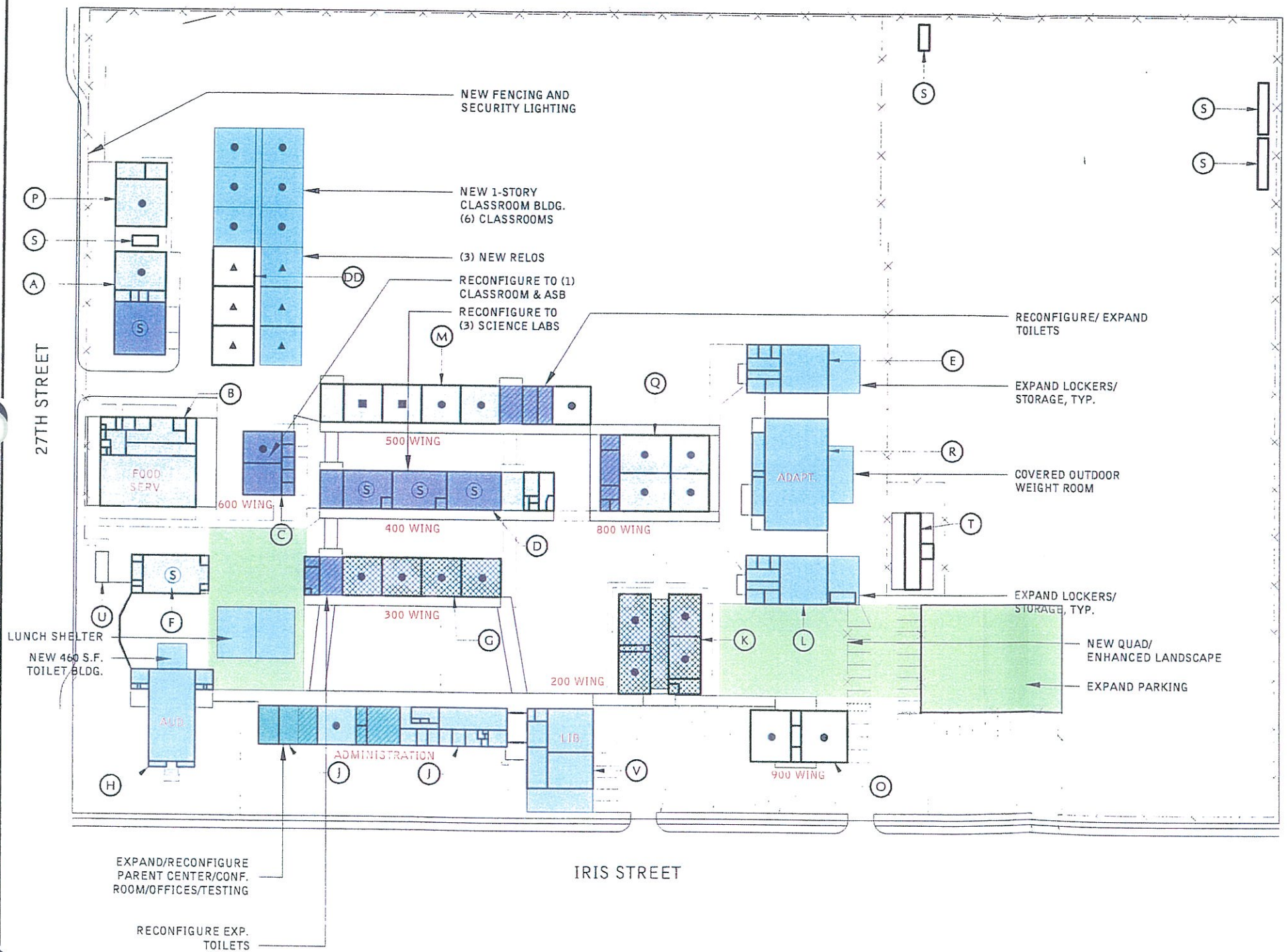

CBEDS 2001 = 1,157 students

SUGGESTED FUTURE ENROLLMENT = 1,170 students
Maturity = 585 students
Peak Enrollment = Now
Potential Boundary = with MVMS
Adjustment or Enrollment Policy Change

CAPACITY W/ SPECIAL ED. = 37(30)+2(13) S.E. = 1110+26 S.E. = 1136 Students

SPECIAL ED S/NS 2001 = 1/23 Students = 2 Classrooms
Teaching Stations = 37 Classrooms

LEGEND

- Permanent Classroom
- Relocatable Classrooms
- Science Labs
- Special Ed Classrooms
- Support / Administration

Scope #1

- Modernization (60/40 State/District)
- Modernization (Remaining Measure BB Funds)
- Reconfiguration (Remaining Measure BB Funds)

Scope #2

- New Construction (50/50 State/District)

Scope #3

- Modernization/Expansion/ New Construction (100 % District)
- Reconfiguration (100% District)
- Enhance Hardscape/Landscape

Job No. 22037.10
Filename SouthwestMSMP
Date 08-06-03
Scale 1" = 100'
Sheet

17848 Sky Park Circle
Irvine, California 92614
P 949 | 261-1001
F 949 | 260-1190
E lpa@lpa.com
W www.lpa.com

LPA
Architecture
Planning
Interior Design
Landscape Architecture
Graphics

Southwest Middle School
Sweetwater Union High School District
1685 Hollister Street, San Diego, CA 92154
(C) Copyright 2003

Facility Needs Assessment and Master Plan

Southwest Middle School
Sweetwater Union High School District

School Summary Break-out By Building

Summary By Category

#	Building	Area	Unit	Category					Total \$
				Modernization	Technology	ADA/Life Sfty	Reconfiguration	Augmentation	
	A Shop Building	3,612	SF	\$418,354	\$56,638	\$125,807	\$58,565		\$659,364
	B Cafeteria	5,989	SF	\$656,639	\$101,115	\$214,706			\$972,460
	C Classroom	2,250	SF	\$215,863	\$34,804	\$68,189	\$31,800		\$350,656
	D Science Classrooms	4,950	SF	\$678,422	\$78,642	\$308,939	\$155,025		\$1,221,028
	E Boy's Shower & Locker	3,992	SF	\$282,577	\$43,515	\$148,447		\$259,639	\$734,178
	F Shop	2,075	SF	\$251,674	\$36,658	\$62,738			\$351,070
	G Classroom	4,621	SF	\$578,161	\$75,814	\$146,232	\$106,331		\$906,538
	H Auditorium	3,186	SF	\$332,499	\$56,319	\$135,483			\$524,301
	J Administration	2,932	SF	\$328,415	\$50,720	\$84,333	\$18,865		\$482,333
	J Classroom	3,321	SF	\$410,869	\$64,963	\$55,124	\$35,673		\$566,629
	K Classroom	4,903	SF	\$496,061	\$70,025	\$139,175			\$705,261
	L Girl's Shower & Locker	3,616	SF	\$252,159	\$37,998	\$155,072		\$259,639	\$704,868
	M Classrooms	6,337	SF	\$741,493	\$110,176	\$340,888	\$124,808		\$1,317,365
	O Music	2,996	SF	\$653,815	\$81,222	\$69,760			\$804,797
	P Shop Building	2,003	SF	\$219,265	\$34,516	\$81,356			\$335,137
	Q Computer Classroom	4,392	SF	\$444,494	\$118,811	\$162,182	\$16,400		\$741,887
	R Multi-Purpose	7,453	SF	\$496,605	\$100,033	\$73,756		\$372,876	\$1,043,270
	S Storage		SF	Not A Part Of Scope					
	V Library	8,353	SF	\$240,328	\$26,746	\$39,166		\$218,529	\$524,769
	AA Relocatable Classroom (demo only)	* 3,890	SF	\$31,613					\$31,613
	BB Relocatable Classrooms (demo only)	* 1,920	SF	\$17,636					\$17,636
	CC Relocatable Classrooms (demo only)	* 5,760	SF	\$45,591					\$45,591
	DD Classroom		Of Scope	Not A Part Of Scope					
	EE Classroom (demo only)	* 960	SF	\$10,647					\$10,647
	Y Relocatable Classroom (Leased)	*	SF						
	Covered Walkways	33,526	SF	\$424,870				\$91,056	\$515,926
	Sitework	N/A	SF	\$3,062,380	\$672,117	\$807,613		\$420,221	\$4,962,331
	New Augmentation	9,680	SF					\$2,118,273	\$2,118,273
Totals		*AIA Area = 110,364	SF	\$11,290,430	\$1,850,832	\$3,218,966	\$547,466	\$3,740,233	\$20,647,927